

BACA COUNTY

By William H. Bauer

Baca County occupies the southeastern corner of the state of Colorado. With the creation of Colorado Territory in 1861, this area was included in the original boundaries of Huerfano County. On February 9, 1866 Huerfano County was carved up and the southern portion, extending east to the Kansas border became Las Animas County. The next reduction was April 16, 1889 when Baca County was created with boundaries that have seen only minor adjustments since that time. Springfield has been the county seat since the creation of the county.

Baca County is rectangular in shape, 58 miles east-west and 45 miles north-south. Baca County is bounded on the west by Las Animas County, on the north by Bent and Prowers Counties, on the east by Kansas and on the south by Oklahoma and for a short distance New Mexico. For the most part it is rolling prairie drained by numerous seasonal streams. The Cimarron is the only major river in Baca County cutting across the far southeastern corner of the county. The streams in the southern third of the county drain southward towards the Cimarron. In the remainder of the county the drainage is primarily easterly into Kansas and eventually also to the Cimarron River. A small part of the northwestern corner of the county drains northward to the Arkansas River.

Water has been the dominant fact of life for Baca County. The lack of permanent streams slowed the early settlement. In the early 1880's higher than normal rainfall convinced people that agriculture was possible in southeastern Colorado. There was a land boom that was really the first wave of settlement and led to the establishment of numerous towns across eastern and northern Baca County and in 1889 the formation of Baca County. Unfortunately the high rainfall was not the normal situation and a drought in the early 1890's destroyed expectations and most of the new, agriculture-based communities quickly died. Ranching did continue and a few towns survived the downturn and an occasional ranch acquired a post office to serve the surrounding countryside. In the 1920's a second land boom developed, this time based on new developments in dry-farming techniques. However, this boom ran head on into the Dust Bowl years of the 1930's and once again communities disappeared and the focus returned to livestock production. A third cycle commenced after World War II with farming now relying on a combination of dry-farming and irrigation from deep wells. Today the situation is one of increasingly larger farms and ranches with the population centered on a handful of towns, of which Springfield is the major business center.

An additional development is the creation of the Comanche National Grasslands in southern Baca County. Ranchland is continuously being added to this national reserve. Another potential change to agriculture in Baca County is the coming of large hog farms. Although not yet a major factor in the county, the sparsely populated prairies of Baca County are attractive to this industry.

Early travel across Baca County was along widely spaced trails. The Cimarron Branch of the Santa Fe crossed the southeastern corner of the county, following the Cimarron River. The Granada Wagon Road crossed the northwestern corner of the county on the way to Fort Union, New Mexico. The Aubrey Trail entered Baca County at about the point where US 160 does today. It then went south and west to exit the county south of present day Campo and east of US 385 & 287. The National Cattle Trail was a short distance from and parallel to the eastern border of the county. Surprisingly, none of these routes developed as permanent roads.

Today, Baca County is quartered by two main highways. US 10 enters from Kansas on the east and exits into Las Animas County on the west. US 385 & 287 enters from the north (coming from Lamar) and exits south into Oklahoma on the way to Boise City. These two highways intersect at Springfield, another factor contributing to Springfield's prominence in the county.

An extensive county road system serves the county. Either numbers or letters designate the county roads. The north south roads are numbered, beginning at Road 0 (zero) on the Las Animas County line

and going eastward to Road 57 on the Kansas Line. The east west roads start with Road A at the Oklahoma border and progress north to Road XX on the border with Prowers and Bent Counties. In the lettering scheme, there is no Road I, Road O, Road II, or Road OO. This regular land survey grid applies through the entire county except the southwestern and northwestern corners where the topography forces travel to follow stream courses.

Take heed, that as the Comanche National Grasslands expand and as ranches and farms become increasingly larger, an increasing number of what were once County Roads have either been eliminated or are now closed to public travel.

The Atchison, Topeka and Santa Fe built the few railroads that still serve Baca County. One line begins at Las Animas, enters Baca County in the northwestern corner and goes southeast to Springfield, then south through Campo and on to Boise City in Oklahoma. Another branch of the Santa Fe, constructed as the Dodge City and Cimarron Valley Railroad parallels US 160 from the Kansas border to Springfield and on to a terminus at Pritchett. The plan was for this railroad to continue west but recognizing that there would be insufficient traffic to support the road, it was terminated at Pritchett.



Overview of Baca County with Corrizo/Carrizo ruins
Photo by William H. Bauer October 3, 1997

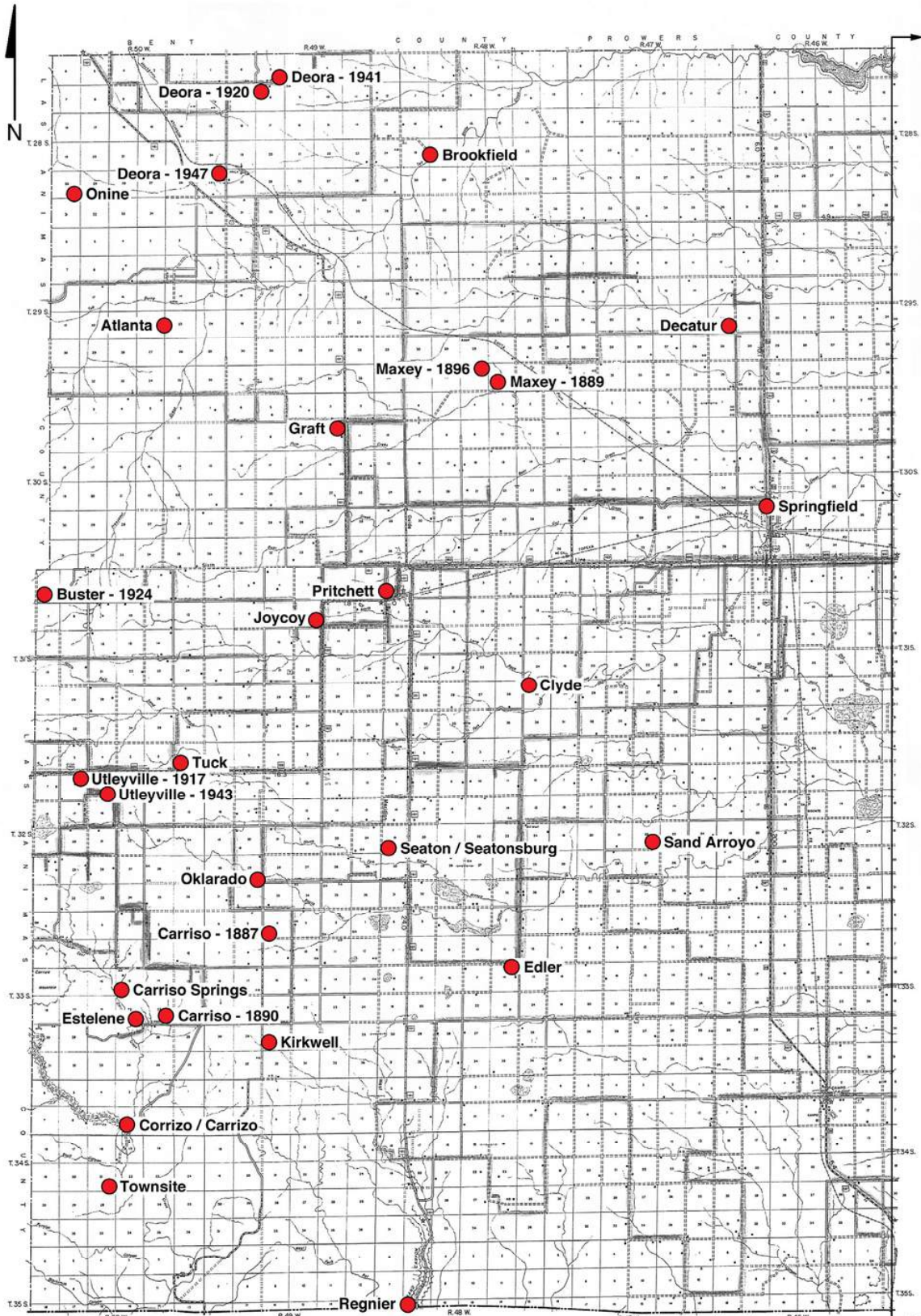

NEW MEXICO O K L A H O M A

Post Office Location Map - Western Baca County

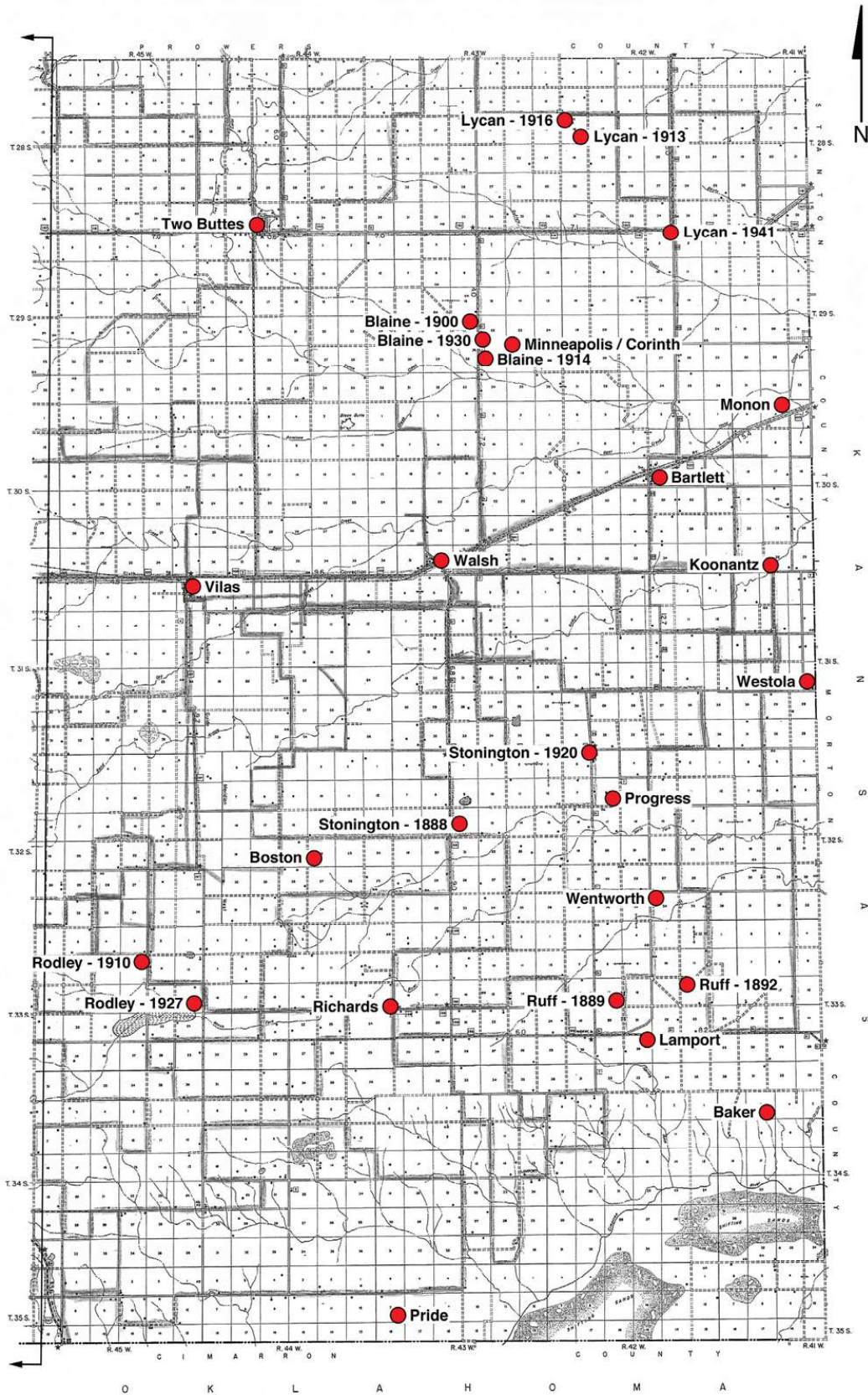

Post Office Location Map - Eastern Baca County

DIRECTIONS TO THE POST OFFICE SITES IN SOUTHWESTERN BACA COUNTY

In addition to Carriso, Carriso Springs, Carrizo and Corrizo several other offices were located in the area along and south of US 160 and from the Las Animas County line east to Baca County Road 8. To hopefully simplify matters and to avoid repetition I am describing a “circle” trip that will visit all of these sites with a minimum of backtracking.

Begin the trip at the junction of US 160 and County Road 2 (two miles east of the Las Animas County line). UTLEYVILLE was originally located in the southwest corner of this intersection. Drive one mile east on US 160 to Road 3 and one mile south to the later location of UTLEYVILLE, on the east side of Road 3. Continue south on Road 3 another five miles (six miles from US 160). CARRISO was located here at the time it closed in 1895. A mile further south, at Road P, Road 3 begins to wander along the east side of West Carrizo Creek. Another mile south brings you to the claimed site of CARRISO SPRINGS. Continue south to a “T” intersection with Road M. About a mile east of this intersection, Road M straightens into an east-west road. ESTELENE was located here. Another mile east was the site of CARRISO in 1890. Continue east another mile to Road 6 and turn south. About two and a half miles will bring you to another intersection. Make note of this intersection, as you will have to return to it. Turn west for another two miles and an at-grade crossing of West Carrizo Creek. Road 3.5 intersects here with what I believe was Road J. Things get confusing in this part of the county where the roads do not follow section lines. CORRIZO/CARRIZO was located in the flat area where Cottonwood Creek joins West Carrizo Creek. Continue south a little more than two miles to the Dunlap Ranch. This was the probable location for the TOWNSITE post office.

Reverse direction, back across West Carrizo Creek some four miles to the intersection referenced above. Now drive east, curving southeast a little more than two miles to another “T” intersection (Road 8 ?). Turn north and in two miles you should be forced to turn east on Road K, a half mile to Road 8 and then forced to turn north. One mile north of the turn to the north is the site of KIRKWELL. In another mile you will cross Road M. Three miles further north, on the east side of Road 8, is the original (1887) site of CARRISO. Two miles north of here, on the west side of Road 8 was the location of OKLARADO. From the site of Oklarado, drive north to Road U, turn west three miles to Road 5 and two miles north to US 160. TUCK was in the northeast corner of the intersection of Road 5 and US 160. You have now returned to civilization and are on your own for further adventures in Baca County.

ATLANTA

The settlement of Atlanta was apparently so named because its organizers were from Georgia. It was established in the fork between Two Buttes and Freezeout Creeks, about ten miles southwest of Brookfield. It flourished for a short time, with a doctor’s office, church, café, general store, two saloons and even its own newspaper, the *Atlanta Democrat*. However, within four years the first Baca Land Boom came to an end and with it Atlanta.

In 1997 only a single, abandoned ranch is present near the site of Atlanta. There are no remaining buildings in the angle between the two creeks. To reach the site of Atlanta, begin at Pritchett. Drive west on County Road DD to County Road 10. Ten miles north, Road 10 will wander about a mile and half and intersect Road QQ. Go west four miles on Road QQ to Road 5, then south about two and a half miles. This will bring you into the area between the two creeks and to the abandoned ranch.

Latitude = 37:30:13-North Longitude = 102:59:44-West

Chronology of the Post Office

Sep 21 1887	--	W/2 Sec 23 T29S R50W	1/2 mile south of Butte Creek.
		Proposed postmaster - John Jay Thompson	
Dec 13 1887		Established	First listed in 1890 P.O. Guide

ATLANTA – Continued

Dec 13 1887	Thompson, John Jay
Dec 23 1887	Fosdick, Sherman
Jan 5 1889	Hail, Wesley M.
Apr 30 1892	Bruner, Eliza J.
Oct 13 1894	Hickler, George S.
Apr 25 1899	Godwin, Thomas
Aug 31 1899	Discontinued Papers to Maxey

Confirmed types of postal markings

NO POSTAL MARKINGS HAVE BEEN REPORTED FROM ATLANTA

BAKER

The published literature is virtually silent with regards to Baker. The only mention describes it as a “rural post office, southeast of Stonington.”

Beginning from Baca County Road M, drive south on Road 55. This road goes only a mile, with the site of Baker yet another mile to the south. From the end of Road 55 nothing is visible. Baker was the southeasternmost post office in Colorado.

Chronology of the Post Office

Jun 15 1914	---	SW/4 Sec 5 T34S R41W About 2-1/4 miles north of the Cimarron River. Applicant for postmaster - Katie Woodard
Feb 27 1915		Established
Feb 27 1915		Woodard, Katie
Nov 16 1916		Beckman, Julia F.
Jun 30 1921		Discontinued Mail to Stonington

Confirmed types of postal markings

1 BAKER, / COLO.
CI 10P 31.5

Oct 26 1915 May 16 1918

4bars S-25x19mm

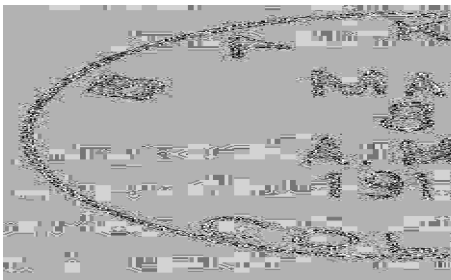
**BARTLETT**

Following the arrival of the Dodge City and Cimarron Valley Railway in 1926 a section point named Bartlett was established by the railroad. On December 20, 1926 Melvin H. Frush filed a town plat for Bartlett. The Dodge City and Cimarron Valley was a subsidiary of the Atchison Topeka & Santa Fe and the section point was named for an official of the railroad.

In addition to serving the railroad, Bartlett was a local supply center for surrounding farms. Bartlett was platted in 1926, but its fate was to face the dust bowl years of the 1930's. It failed to survive and as a town, it was gone from the landscape by 1940.

The site of Bartlett is on US 160, about six miles east of the Colorado-Kansas border at the junction with County Road 51. There are still a few buildings on each side of the highway and a grain elevator. The cited post office location plots on the south side of the highway. In 1997 there was still one building that appears to have been a store and could have also held the post office.

BARTLETT – Continued

Latitude = 37:26:00-North Longitude = 102:08:37-West

Chronology of the Post Office

Sep 5 1928	Established	
Sep 5 1928	Shyer, Thomas A.	Confirmed
Sep 6 1928	---	SW/4 Sec 15 T30S R42W
		3 miles south of Bear Creek. 712.5 feet south of the DC&CV Railroad
		Applicant for postmaster - Thomas A. Shyer
Sep 27 1928	Shyer, Thomas A.	Commissioned
Oct 12 1928	Shyer, Thomas A.	Assumed charge
Mar 17 1938	Ordered closed	
Mar 31 1938	Discontinued	Mail to Walsh

Confirmed types of postal markings

1	BARTLETT, / COLO.	Jul 15 1930	Mar 31 1938
	CI 10P 32.0		
		4bars S-24x19mm	



BLAINE

Blaine was a product of Minneapolis. Minneapolis failed to pay off an issue of municipal bonds. Most of the businesses and residents moved a short distance west, across the section line and established a new town they named Blaine for an early settler in the area. Blaine survived the Dust Bowl years and was a small farming center until well into the mid-twentieth century.

The Post Office Department recorded four sites for the Blaine Post Office. All of them are located within a two-mile stretch along Baca County Road 45, centering on the intersection with Road MM. The site a mile north of the intersection and just south of a modern ranch, is an open field. At the intersection there are some old buildings and the Minneapolis Cemetery. Two other sites were within the first mile south of this point but there is nothing present at either location.

About 1909 some Artesian wells were drilled south of Blaine (site 2). This site first took the name of Artesia, but when the Blaine post office moved to that point the name Artesia ceased to be used.

Chronology of the Post Office

May 28 1900	---	NE/4 Sec 21 T29S R43W
		Two miles north of Horse Creek. There may have been an intention to re-establish Minneapolis at this location.
		Proposed postmaster - Lillian Y. Brackney
Aug 4 1900	Established	
Aug 4 1900		Brackney, Lillian T.
Feb 17 1909		Wilkins, Nora N.
Dec 31 1913		Risce, John W.
Feb 25 1914	---	NW/4 Sec 27 T29S R43W 1/2 mile north of Horse Creek.
Mar 27 1916		Warren, Uriah J.
Oct 4 1917		Sedbury, Jack
Jan 4 1918		Wheeler, John T.
Dec 10 1919		Toole, George G.

BLAINE – Continued

Jul 24 1920	Toole, Edna N.	
May 5 1921	Meader, Marie W.	
Apr 15 1925	Johnson, Ethel B.	Acting
Jul 21 1925	Johnson, Ethel B.	Appointed
Aug 1 1927	Bland, Sam	Acting
Aug 16 1927	Bland, Sam	Confirmed
Sep 12 1927	Bland, Sam	Commissioned
Feb 18 1930 --	SW/4 Sec 22 T29S R43W A move 157 rods northwest of a previous location. 1 mile north of Horse Creek.	

NOTE: "I took charge of this office July 1st 1927 and it was then located SW/4 Sec 27 T29S R43W and has been there all this time until I asked to move it to Sec 22-29-43 but I hear by patrons of this office that about 1917 a Mr. Sedling [sic] P M at that time did get permission to move it to Sec 3 T30S R43W but it wasn't [sic] moved. I moved it to Sec 22-29-43 March 16, 1930." Samuel M. Bland – Postmaster, March 20, 1930

Aug 28 1939	Ordered closed
Sep 15 1939	Discontinued Mail to Lycan

Confirmed types of postal markings

1	BLAINE / COLO. CI 10P 29.0	Hstp Cork, smudge	Oct 1 1907
1.1	BLAINE. / COLO. CI 10P 31.0	4bars S-24x13mm	Sep 7 1911 Jun 24 1913
2	BLAINE. / COLO. CI 10P 31.0	4bars S-25x20mm	Apr 15 1915 Jul 14 1919
3	BLAINE, / COLO. CI 10P 32.0	4bars S-??x19mm	Jul 19 1920
4	BLAINE. / COLO. CI 10P 33.0	4bars S-24x20mm	Mar 12 1933 Sep 15 1939

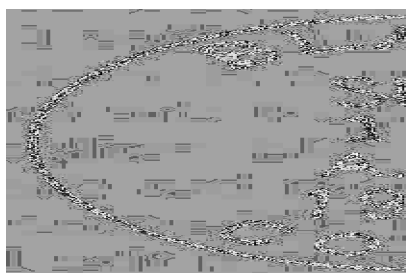
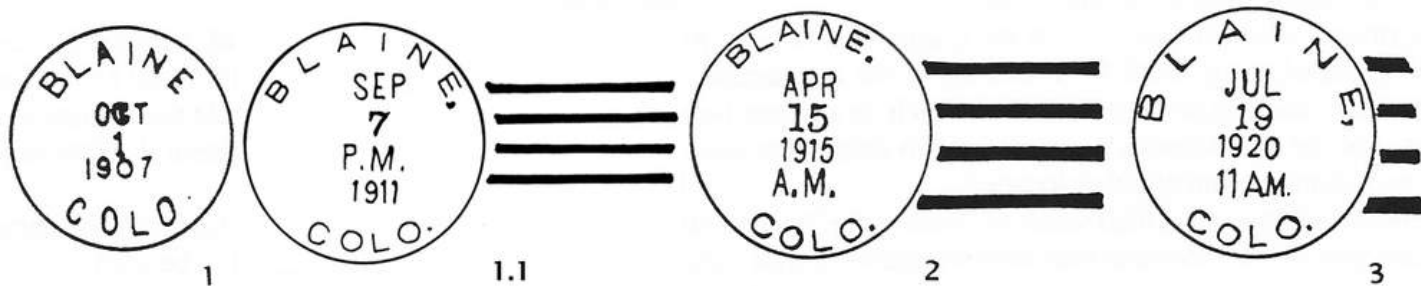

BOSTON

On November 22, 1886, five men from Richland and Ashland, Kansas filed incorporation papers for the Atlantis Town Company with the Colorado Secretary of State. On the same date a survey of the new townsite of Boston was completed. On August 11, 1887 all fifty citizens of Boston voted for incorporation. Many of the new settlers were from Massachusetts and the town was named for Boston in that state.

BOSTON – Continued

Boston was needed as a trading center for a growing ranch area and to serve the cattle trails from Texas. Boston grew quickly and soon had a bank, drugstore, hardware store, three livery barns, the three-story Boston House, five saloons and a post office.

However, Boston soon earned a reputation as the largest and most lawless of the new towns in Baca County. That reputation, the failure to acquire the county seat and the drought of 1893 that ended the land boom, spelled the end for Boston. In its dying days it competed with nearby Vilas, but Vilas was the winner and by 1893 no trace of Boston remained.

Today, nothing remains of the original Boston. There is a farm complex in the general area and one report refers to a “few tombstones in the corner of a field.” From Walsh, drive nine miles south on Road 44 to Road U, then four miles west to Road 41. This places you about a mile north of the approximate location of Boston and the previously mentioned farm. From here, there is no access to the location, nor from a similar position a mile west and a mile south on Road 40.

Chronology of the Post Office

Mar 21 1887	---	SW/4 Sec 22 T32S R44W 2-1/2 miles north of the North Fork of the Cimarron River Proposed postmaster - Samuel M. Konkel (?)	
Apr 14 1887		Established	
Apr 14 1887		Alexander, Andrew B.	
May 14 1889		Matthews, Lewis F.	Appointment rescinded Feb 28, 1890
Apr 14 1887	[1890?]	Alexander, Andrew B.	Resumed duties
Dec 24 1890		Clayton, Joseph G.	
Jun 16 1893		Discontinued	

Confirmed types of postal markings

- | | | | | |
|----------|-----------------------|--|--------------------|--------------------|
| 1 | BOSTON / COLO. | | Sep 16 1887 | Dec 12 1887 |
| | CI 10P 26.0 | Hstp Fancy, positive star-in-circle | | |
| 2 | BOSTON / COLO. | | Jun 12 1889 | |
| | CI 10P 27.0 | Hstp Target, 4-ring | | |

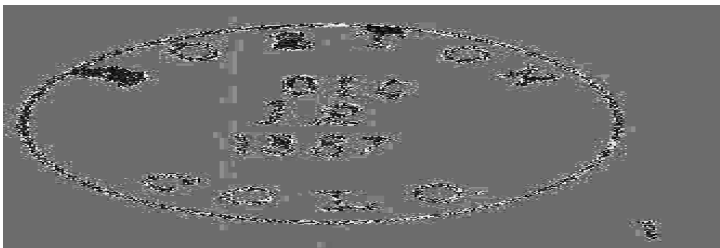

BROOKFIELD

In the summer of 1887 in the midst of the Baca County land boom, a group of businessmen from Morton County Kansas organized the Brookfield Town Company to develop a town on Two Butte Creek. The chosen location was on a segment of the wagon road from Granada, Colorado to Fort Union, New Mexico. The town plat was filed August 24, 1888 and was named after Brookfield, Massachusetts. Brookfield was another of many towns in southeastern Colorado that had a lively growth during the wetter than normal years of the mid and late 1880’s, but then quickly died with a return to the more normal arid weather in the 1890’s.

The site of Brookfield is sixteen miles, almost due north of Pritchett. From US 160, north of Pritchett, drive thirteen miles north on Road 11, one mile west on Road SS, three miles north on Road 11 and one mile east on Road VV. At that point a bladed track runs south along the section line. A mile south was the site of Brookfield. In 1997 there was still standing a single stone building, abandoned and with the roof caving in - all that remains of Brookfield.

BROOKFIELD – Continued



The only remaining building at the site of Brookfield, Colorado

Photograph by William H. Bauer

October 3, 1997

Chronology of the Post Office

Aug 3 1887	---	Center Secs 19&20 T28S R48W 1/4 mile south of Butte Creek. Proposed postmaster - William Powell
Aug 30 1887		Established
Aug 30 1887		Powell, William
Feb 28 1890		Bireley, James W.
Mar 29 1892		Munro, George
Oct 11 1894		O'Niell, Nellie B.
Jul 3 1902		Ordered closed
Jul 15 1902		Discontinued Papers to Lamar

Confirmed types of postal markings

1 BROOKFIELD / COLO.
CI 10P 27.0

Sep 19 1888 Feb 9 1889
Hstp Target, 4-ring 17mm



BUSTER

Buster was only a rural post office and not a town. The post office was first located in Las Animas County, approximately five miles northeast of Andrix. By 1924, maps located it nine miles to the northeast at a site that was barely in Baca County. I have not found any suggestions as to the origin of the chosen name.

From the south side of Pritchett, US 160 goes west two and a half miles to where it again turns south. The westward continuation of US 160 is County Road CC. Drive west on Road CC nearly to the county line. Three-tenths of a mile east of the county line and about 200 feet north of Road CC there are some stones that likely represent an old foundation. Also there are parts from a Model T and some scattered trash from human occupation that are consistent with the 1920's time period. This is a probable location for the Baca County site of Buster.

Chronology of the Post Office

Jul 28 1916	Established (Las Animas County)	
Jul 28 1916	Fosnight, Charles R.	
Mar 13 1919	Melton, Hughie E.	
Apr 13 1921	Shelton, Jessie E.	
Jan 13 1922	Pemberton, Noah W.	
Aug 9 1924 ---	SW/4 Sec 6 T31S R50W	
	A move 1-1/4 miles east of previous location. 1-1/2 miles west of Soldier Creek.	
	County change (Las Animas to Baca) Sketch map show previous location in	
	SE/4 SE/4 Sec 2 T31S R52W.	
Jan 27 1925	Williams, Amanda E.	
Mar 20 1926	Rutherford, Mary F.	Acting
Mar 29 1926	Rutherford, Mary F.	Appointed
Jul 15 1927	Ordered closed	
Jul 30 1927	Discontinued Mail to Graft	

Confirmed types of postal markings

1	BUSTER, / COLO.	Nov 20 1916
	CI 10P 32.0	4bars S-??x18mm



Ed. Note: This postmark was struck during the time when Buster was located in Las Animas County. I have chosen to include it here as there is a probability that it continued in use after the move to Baca County.

CAMPO

There are historical references that date the establishment of Campo and the Campo Post Office as early as 1909. However, other references give 1912 as the year of establishment and that is more consistent with the Records of Postmaster Appointments. Regardless of the year of establishment, George W. Petty did not file a town plat for Campo until September 16, 1927 and the town was not incorporated until 1950. The major impetus for growth at Campo was the arrival in 1937 of the Santa Fe Railway. For a little more than a year the Campo Post Office was located in Section 26, Township 33 South, Range 46 West. In 1914, it moved about three miles south-southwest to its present location.

“Campo” is the Spanish word for “field.” The choice of a name is attributed to Francis M. Wheeler, who was the first postmaster.

CAMPO – Continued

In the present day, Campo is a modest trading center for a large portion of southern Baca County and it is located at the intersection of Road J with US 287/385, a few miles north of the border with Oklahoma. The early site is an open field, a mile east of Road 28 and a mile south of Road M.

Latitude = 37:06:18-North Longitude = 102:34:45-West

Chronology of the Post Office

Jan 11 1913	---	SE/4 Sec 26 T33S R46W	Suggested names were: Darrow, Fay, Baca Applicant for postmaster - Llewellyn W. Jackson
Apr 10 1913		Established	
Apr 10 1913		Wheeler, Frances M.	Presidential Oct 1, 1921
Mar 3 1914	---	NW/4 Sec 11 T34S R46W	1/2 mile south of the North Fork of the Cimarron River.
Jan 20 1922		Wheeler, Frances M.	P&S [Apptd by President & confirmed by Senate]
Oct 4 1924	---	NW/4 Sec 11 T34S R46W	
Jan 26 1926		Wheeler, Frances M.	P&S
Apr 17 1927		Foster, Frances	Acting
Jan 12 1928		Miller, John M.	Confirmed
Mar 18 1932		Miller, John M.	Nominated
Apr 4 1932		Miller, John M.	Confirmed
May 3 1932		Miller, John M.	Commissioned
Jun 1 1936		Wells, Bailey M.	Acting
Jun 5 1936		Wells, Bailey M.	Nominated
Jun 11 1936		Wells, Bailey M.	Assumed charge
Jun 16 1936		Wells, Bailey M.	Confirmed
Jun 20 1936		Wells, Bailey M.	Appointed Presidential
Jul 8 1936		Wells, Bailey M.	Commissioned
Jul 15 1936		Wells, Bailey M.	Assumed charge
May 20 1940		Wells, Bailey M.	Nominated
May 24 1940		Wells, Bailey M.	Confirmed
Jun 20 1940		Wells, Bailey M.	Appointed Presidential
Aug 9 1940		Wells, Bailey M.	Commissioned
Aug 15 1940		Wells, Bailey M.	Assumed charge
Oct 21 1941	---	NE/4 Sec 10 T34S R46W	
Jul 31 1959		Smith, Clarence G.	Assumed charge
Aug 4 1959		Smith, Clarence G.	Acting
Apr 27 1961		Casper, Charles E.	Nominated
Jul 10 1961		Casper, Charles E.	Confirmed & Appointed Presidential
Jul 31 1961		Casper, Charles E.	Commissioned
Aug 18 1961		Casper, Charles E.	Assumed charge

Confirmed types of postal markings

1	CAMPO. / COLO. CI 10P 32.0	4bars S-24x19mm	Apr 22 1915
2	CAMPO / COLO. CI 10P 30.0	Dplx Grid, 9-bar oval	Feb 24 1924 Jul 27 1938
3	CAMPO / COLO. CI 10P 30.0	Dplx Grid, diamond with 1	Aug 12 1939 Sep 4 1950
4	CAMPO, CO / 81029 CI 10P 33.0	4bars S-24x19mm	Jan 26 1966 May 31 1975
4.1	CAMPO, CO / 81029 CI 10P 33.0	4bars S-25x20mm	May 29 1990 Dec 23 1991
5	CAMPO. CO / 81029 CI 10P 33.0	4bars S-24x19mm	Mar 29 1993 May 3 1993

CAMPO – Continued



CARRISO

It is easy to become confused with the group of post offices that were named Carriso, Carrizo, Corrizo and Carriso Springs. All of these offices existed at one time or another between 1887 and 1916. Corrizo and Carrizo were at the same location and the difference in name is a spelling change that occurred in 1907.

It appears that the basic name for these settlements is a Spanish word that means “reed grass.”

Between June 1887 and July 1895, the Carriso Post Office had three periods of life, each at a different location (see map). The Carriso Springs office overlapped the first period of operation of Carriso and may have been followed by the second version of Carriso, which was only a short distance from it.

All of these settlements were in the southwestern corner of Baca County and were associated with some unsuccessful attempts to mine copper, lead and silver in that area and also to the west in Las Animas County.

The records of Postmaster Appointment seem to indicate that Carrizo was originally known as Townsite. This seems unlikely as the periods of operation of these offices overlapped and the locations are about three miles apart.

E. C. Murray filed a town plat for Carriso on October 3, 1888. This settlement lasted a little more than a year, dying because of the lack of an adequate water supply. The historical literature makes reference to the later settlements by this name.

The 1887 site on Road 8 is open field with no visible remains. There are some ruins at the 1883 site, on Road 3. The 1890 site on Road M is also an open field with no visible remains of Carriso.

Chronology of the Post Office

- Mar 24 1887 --- SW/4 Sec 4 T33S R49W 5 miles east of Carriso Creek
Proposed postmaster - John W. Taylor
CARISSO - (Really a re-establishment of "Carriso Springs")
- Jun 2 1887 Established
- Jun 2 1887 Taylor, John W.
- Aug 6 1889 Wardell, Joseph T.
- Dec 26 1889 Discontinued Papers to Carriso Springs

CARRISO – Continued

Sep 13 1890	---	SE/4 Sec 23 T33S R50W 1/4 mile west of East Carrizo Creek. Sketch map plots and label it as in Section 22! Proposed postmaster - Henry J. Rupert
Oct 30 1890		Re-established
Oct 30 1890		Rupert, Henry J.
Mar 3 1891		Discontinued Papers to Springfield
Dec 16 1893	---	NE/4 Sec 9 T33S R50W On west side of Carrizo Creek. Proposed postmaster - James Murray
Apr 17 1894		Re-established
Apr 17 1894		Murray, James
Jul 11 1895		Discontinued Mail to Kenton, Oklahoma

Confirmed types of postal markings

1	CARRISCO / COLO. CI 10P 27.0	Oct 12 1887 Hstp Target, 4-ring 18mm
---	---------------------------------	---

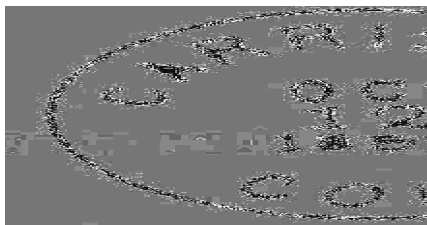

Note the misspelling "Carrisco" in the cds.
The only reported copy (illustrated here) was
in the Segerstrom collection.

CARRISO SPRINGS

In November of 1887 J. H. Concannon recorded the town site of Carriso Springs. Construction of the town began December 17, 1887 and William McClane filed a town plat on February 10, 1888. By 1893 the site was deserted. Early growth was slow, but there was a brief boom stimulated by copper, lead and zinc discoveries in the area. The ore was of mediocre quality, hard to mine and a long transport was required to reach the nearest rail line.

For directions to this post office location, see CARRISO.

No remnant of Carriso Springs was observed at the plotted location.

Latitude = 37:09:49-North Longitude = 103:02:04-West

Latitude = 37:09:57-North Longitude = 103:00:58-West CARRIZO SPRINGS CEMETERY

Chronology of the Post Office

Nov 15 1887	---	SW/4 Sec 15 T33S R50W The simple name of "Springs" was rejected. 1/4 mile west of Corrizo Creek Proposed postmaster - Mary Jane Robinson
Aug 27 1888		Established
Aug 27 1888		Robinson, Mary J.
Jan 23 1890		Crane, Lovina
May 17 1890		Discontinued Papers to Springfield

Confirmed types of postal markings

1	CARRISO SPGS. / COLO. CI 10P 27.0	Jul 22 1889 Hstp Target, 3-ring 17mm
---	--------------------------------------	---

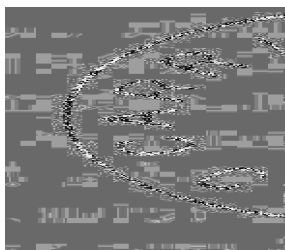

CARRIZO

This settlement was something of a company town, associated with the Bear Canyon Copper Company. It was about six miles south of Carriso Springs and was preceded in the general area by Townsite. Like Carriso Springs, its fortunes depended on the mining and when that failed, so did the town (see Corrizo).

The junction of Roads 3.5 and J is in a flat, open area with numerous cottonwoods and some evidence of buildings having been there at some time in the past. As we approached this area on our return from Townsite to the south, we spotted some signs of mining activity on the hillside to the west of the creek. Apparently there was a small mill at that location.

For directions to this post office, see CARRISO.

Chronology of the Post Office

Sep 21 1907	Established	
Sep 21 1907	Tucker, Clara	Rescinded
Nov 27 1907	Establishment Rescinded	
Dec 14 1907	Formerly spelled Corrizo, Site was known earlier as Townsite	
Dec 14 1907	Shannon, Elizabeth R.	
Feb 14 1908	Davis, William W.	
Jul 13 1908	---	SW/4 Sec 10 T34S R50W 200 yards west of East & West Carrizo Creeks The sketch map shows "Late town site" in SW/4 NE/4 Sec 21 T34S R50W, and "Old Town Site" in SW/4 Sec 1 T33S R50W (accuracy?)
Mar 8 1909	Kelley, Carrie L.	
Mar 11 1910	Scarborough, Birdie	
May 8 1911	Cole, Willard	
Jun 3 1915	Tucker, Oliver W.	
Jan 31 1916	Discontinued	Mail to Estelene

Confirmed types of postal markings

1	CARRIZO, / COLO. CI 10P 31.0	4bars S-23x13mm	Oct 24 1908 Jan 8 1909
2	CARRIZO, / COLO. CI 10P 33.0	4bars S-24x20mm	Dec 4 1915



CLYDE

There is a possibility for some confusion with this office. According to the Records of Postmaster appointments there was a "Clyde" post office in Las Animas County (later to be Baca County) during 1889-1890. However, this office was never listed in the annual Postal Guides and I found no document in the Geographic site Location Reports for either Baca or Las Animas Counties.

It has been reported that The Clyde Land and Town Company was incorporated in November 1886, the papers being filed with the Clerk of Las Animas County. No more than that is known.

In 1913, the name Clyde returned to Baca County, being attached to what was probably a ranch post office about 8 miles southwest of Springfield. This post office lasted until 1920 but nothing more is known about it. The Geographic Site Location Report for the new Clyde specifies a location (see below)

CLYDE – Continued

and also indicates that the preferred name of “Lone Rock” was rejected. I have no explanation for the selection of the name Clyde.

To reach the site (1913) of Clyde, from Springfield, drive west on US 160 to Road 17. Turn south on Road 17 four miles. Clyde was on the east side of the road. The site is an open field with no sign of habitation.

Chronology of the Post Office

Feb 18 1889	Established
Feb 18 1889	Fail, Creed B.
Mar 28 1890	Discontinued No papers sent
Aug 21 1913 ---	NW/4 Sec 25 T31S R48W The suggested name of "Lone Rock" was rejected. 1/2 mile south of Lone Rock Draw. Applicant for postmaster - Mrs. Annie A. Money
Oct 25 1913	Re-established
Oct 25 1913	Money, Annie A.
Mar 2 1914 ---	NW/4 Sec 25 T31S R48W 1/4 mile south of Lone Rock Draw
Oct 26 1916	Mizzles, Absalon[m?] L.
Jun 15 1920	Discontinued Mail to Springfield

Confirmed types of postal markings

1 CLYDE. / COLO. Jul 10 1916 Dec 1 1916
CI 10P 32.0 4bars S-19x24mm

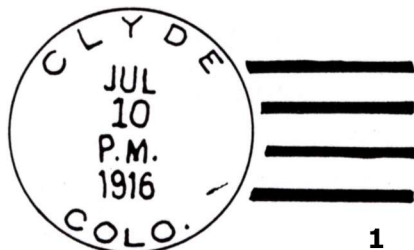
**CORINTH**

The post office at Corinth existed for only six months. It was then moved to nearby Minneapolis, which was growing rapidly. If the Geographic Site Location Reports are correct, Corinth and Minneapolis may have been virtually at the same location. The name originally proposed for a post office at this location was “Butte.”

The Baca County land boom of the late 1880’s was the impetus for the establishment of Corinth.

In 1997, the Minneapolis Cemetery is still identified at the corner of County Roads MM and 45. A few hundred feet east of the cemetery are the ruins of two stone buildings.

From Walsh, drive east on US 160 to Road 45, then north seven miles to Road MM. This will also take you to the sites of Blaine. Corinth/Minneapolis was east of Road 45 on the south side of Road M.

Chronology of the Post Office

Nov 22 1882 ---	NW/4 Sec 26 T29S R43W The suggested name of "Butte" was rejected. 1 mile north of Horse & Bear Creek. Proposed postmaster - Wallace B. McNeil
Mar 18 1887	Established
Mar 18 1887	McNeel [McNeil?], Wallace B.
Aug 12 1887	Moved to Minneapolis

CORINTH – Continued

Confirmed types of postal markings

NO POSTAL MARKINGS HAVE BEEN REPORTED FROM CORINTH

CORRIZO

This was the same place as Carrizo and was perhaps a misspelling of that name. See Carrizo for more information.

For directions to this post office, see CARRISO.

Chronology of the Post Office

Oct 30 1899 --- SW/4 Sec 10 T34S R50W On west side of Carrizo Creek.
Proposed postmaster - David Darling
Dec 13 1899 Established
Dec 13 1899 Darling, David
Jan 14 1901 Vanetten, Adna V.
Mar 27 1903 Emerson, Edward
Apr 23 1903 Condet, Elmer J.
Dec 14 1907 Spelling changed to Carrizo

Confirmed types of postal markings

1 CORRIZO / COLO. May 12 1902
CI 10P 28.0 Hstp Smudge (may be a target)

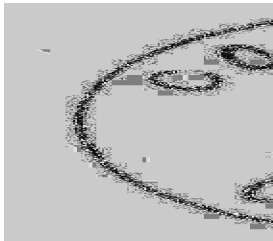

DECATUR

Decatur was another of the post offices that were created during the Baca County land boom, lived a short life and then disappeared from the landscape.

Drive north from Springfield to Road MM, turn west one mile. The site of Decatur is at this point, but it is a well-cultivated field with no remnant of the community. It is unlikely that Decatur was ever much more than a rural post office serving the nearby farms.

Chronology of the Post Office

Jun 29 1888 --- SE/4 Sec 24 T29S R47W
Proposed postmaster - William R. Stricklett
Jul 25 1888 Established
Jul 25 1888 Stricklett, William R.
Aug 4 1889 Hagen, Edward
Mar 21 1890 Smart, Clara
Aug 8 1891 Discontinued Papers to Springfield

Confirmed types of postal markings

1 DECATUR / COLO. Feb 22 1889 Jan 17 1890
CI 10P 28.0 Hstp Target, 4-ring 17mm

DECATUR – Continued

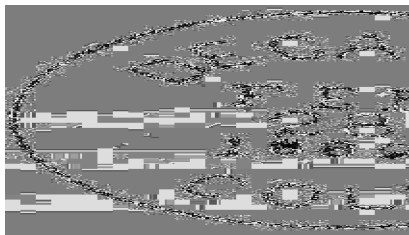

DEORA

Deora was a rural post office that had at least three different locations during its fifty-four year life span. The name, apparently a combination of two Spanish words “De” (of) and “Oro” (gold), was suggested by the first postmaster, Ethel Falk, after the name Falk had been rejected by the Post Office. First established in 1920, this was beyond the time when the Post Office Department looked favorably on a new post office taking the name of its first postmaster.

The area around the sites of Deora is agricultural and ranch land, thus the post office name seems incongruous. Perhaps it was intended as a reference to “golden” wheat fields.

Follow the instructions to reach the site of Brookfield from Pritchett. However continue north on Road 11, one mile from Road VV to Road WW. At the intersection of County Roads 11 and WW, drive west three miles to one of the sites of Deora. There are ruins of a stone building at this site. Continue west on this road another half mile. After cresting a low hill, you will find the ruins of a corral and stable on the south side of the road and on the north side of the road, the ruins of an abandoned store. The store building would have been a likely location for the post office when Deora was at this location in (1920).

Continue west to Road 6 and turn south for three miles to the railroad. The final site of Deora was located a little south of the railroad crossing in the valley. There is an active ranch at this location.

Latitude = 37:34:49-North Longitude = 102:57:58-West

Chronology of the Post Office

Apr 21 1920	Established	
Apr 21 1920	Falk, Ethel	Confirmed
Apr 22 1920	---	W/2 Sec 8 T28S R49W The suggested name of "Falk" was rejected.
		Applicant for postmaster - Ethel Falk
May 20 1920	Falk, Ethel	Commissioned
Jun 16 1920	Falk, Ethel	Assumed charge
Jul 1 1940	Mills, Mrs. Marry A.	Assumed charge
Jul 20 1940	Mills, Mrs. Marry A.	Acting
Sep 25 1940	Falk, Henry C.	Confirmed
Oct 12 1940	Falk, Henry C.	Commissioned
Oct 17 1940	Falk, Henry C.	Assumed charge
Oct 31 1941	---	SE/4 Sec 5 T28S R50W NOTE: While possible, this may be in error; T50W instead of T49W
Mar 5 1944	Carman, Mrs. Cora Belle	Confirmed
Apr 20 1945	Carman, Mrs. Cora Belle	Commissioned
May 18 1945	Carman, Mrs. Cora Belle	Assumed charge
Dec 5 1946	Barker, Alma Ruth	Assumed charge
Dec 26 1946	Barker, Alma Ruth	Acting
Jan 1 1947	---	NE/4 Sec 25 T28S R50W A move 4.95 ?? southwest of a previous location.
		Railroad tracks 1/2 mile north of post office.
May 5 1947	Barker, Alma Ruth	Appointed
Jun 26 1947	Barker, Alma Ruth	Commissioned
Jun 30 1947	Barker, Alma Ruth	Possession
Mar 1 1974	Discontinued	

DEORA – Continued



Ruins of an old store building, possibly the Deora Post Office location in 1941
 Photograph by William H. Bauer October 3, 1997

Confirmed types of postal markings

1	DEORA, / COLO. CI 10P 33.0	4bars S-??x20mm	Jan 17 1923
2	DEORA/ COLO. CI 10P 29.0	Dplx Grid, 9-bar oval	Feb 9 1933 May 1 1944
3	DEORA/ COLO. CI 10P 33.0	4bars S-23x19mm	Aug 18 1947 Nov 17 1951
4	DEORA.CO / 81035 CI 10P 32.0	4bars S-24x19mm	Oct 27 1970 Aug 18 1973

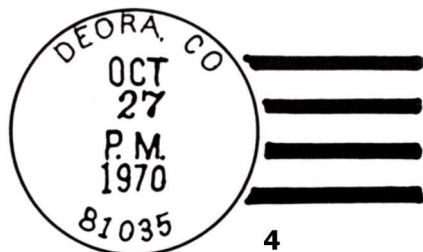

EDLER

For rural Baca County, Edler was a more substantial community than most in this portion of the county and in 1997 it still had a few scattered residents. The settlement was large enough in 1937 to be the site for the construction of a substantial school building. The building, no longer used as a school, but perhaps as a church, was still standing in 1997. There were also an old store and a couple other buildings along what was once the main street of Edler. There is a lot of junk scattered across the landscape, indicative of the once much larger community. The school building is an example of the Depression era, WPA style architecture and construction.

In 1915, when a post office was requested, the name Johnson was proposed, in all probability for the first postmaster, Charles E. Johnson. This name was rejected, likely in part for its similarity to Johnstown in Colorado. The name that was selected honors a Dr. Edler, the first homesteader in the area.

The easiest way to reach Edler is to drive west from Springfield on US 160 to County Road 17. Turn south and it is fourteen miles south to Edler at Road P.

Chronology of the Post Office

Nov 24 1915	---	NE/4 Sec 14 T33S R48W	The suggested name of "Johnson" was rejected. 2 miles south of Sand Arroyo. Applicant for postmaster - Charles E. Johnson
Feb 16 1916		Established	
Feb 16 1916		Johnson, Cha[r]les E.	
Jul 14 1917		Roweth, Charles A.	
May 2 1918		Phillips, Walter	
Oct 7 1927		Russell, Charles	Acting
Jan 27 1928		Teeters, Jesse C.	Confirmed
Feb 13 1928		Teeters, Jesse C.	Commissioned
Feb 18 1928		Teeters, Jesse C.	Assumed charge
Oct 20 1941	---	NE/4 NE/4 Sec 14 T33S R48W	Jansen Creek is 1-3/4 miles north of post office.
Dec 8 1946		Collins, Wesley D.	Assumed charge
Dec 22 1947		Ordered closed	
Dec 31 1947		Discontinued	Mail to Regnier

Confirmed types of postal markings

1	EDLER. / COLO.	[Is there a period??]	Mar 3 1917	Aug 20 1923
	CI 10P 32.0	4bars S-24x19mm		
2	EDLER. / COLO.	[Is there a period??]	Jun 13 1940	Sep 5 1942
	CI 10P 32.0	4bars S-24x19mm		
3	EDLER / COLO.		Aug 26 1947	Dec 31 1947
	CI 10P 33.0	4bars S-23x19mm		



ESTELENE

Estelene is another of the small settlements in southwestern Baca County that were associated with the unsuccessful early twentieth century mining activity in that section of the county. There was a small amount of mineral production, but not enough to sustain the post office for any length of time. Ranching in the surrounding area was and is still a more productive occupation.

For directions to this post office, see CARRISO.

At the plotted location there is evidence of a building foundation and a couple of depressions that may represent the old cellars of some buildings.

Chronology of the Post Office

Mar 7 1910 --- **SE/4 SE/4 Sec 22 T33S R50W Carrizo Creek is 50 yards east of post office.**
Proposed postmaster - Agnes R. Collins

Apr 8 1910 **Established**

Apr 8 1910 **Collins, Agnes R.**

Jul 27 1927 **Ordered closed**

Aug 10 1927 **Discontinued Mail to Utleyville**

Confirmed types of postal markings

0.1	Estelene		Jun 24 1910
	MS	Mscp Pen cancel	
1	ESTELENE, / COLO.		Feb 18 1915
	CI 10P 32.0	4bars S-??x19mm	

Estelene
Colo
June 24
1910 0.1

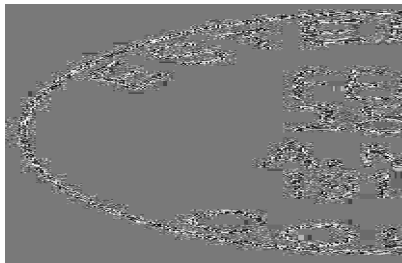

GRAFT

Other than the location and the names of the postmaster, nothing is known about this post office. I believe that it was just one of the many rural ranch post offices in Eastern Colorado.

The originally requested name was "Grafton" but the Post Office Department shortened this to "Graft." Graft is a late example of a post office taking the name of the applicant for postmaster, Horace D. Graft. The first postmaster, Florence Graft was probably his wife.

Graft is on the road to Atlanta that has been previously described. After turning north on Road 10, it is 5 miles to the intersection of County Roads JJ and 10. A half-mile ahead you can see an abandoned building that is at the site of Graft.

Latitude = 37:26:52-North Longitude = 102:53:10-West

Chronology of the Post Office

Apr 29 1916 --- **NE/4 S/2 Sec 10 T30S R49W The name was first suggested as "Grafton."**
1/2 mile north of Plum Creek.
Applicant for postmaster - Horace D. Graft

Aug 12 1916 **Established**

Aug 12 1916 **Graft, Florence D.**

Dec 29 1917 **Graft, John H.**

Apr 13 1921 **Hagen, Roy T.**

GRAFT – Continued

Feb 4 1922	Stogner, Jesse F.	
Jan 3 1923	Graft, Byrd F.	Acting
May 4 1923	Graft, Byrd F.	Appointed
Nov 23 1934	Ordered closed	
Dec 31 1934	Discontinued Mail to Springfield	

Confirmed types of postal markings

1	GRAFT / COLO. CI 10P 34.0	Dec 31 1934 4bars S-24x18mm, Town name is off-center to left
---	------------------------------	---

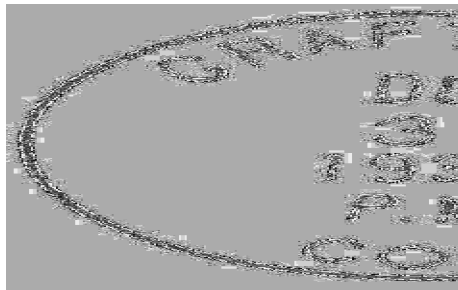
**JOYCOY**

In 1926, the Atchison, Topeka and Santa Fe Railroad laid out the community of Joycoy, in anticipation of building to that location. Local legend is that by the time the railroad reached the site of present day Pritchett, there had been so little interest in Joycoy that the railroad abandoned the original plan and terminated the branch line at what is now Pritchett. Joycoy quickly faded and the post office was moved the few miles east to Pritchett. The applicant for postmaster, Jesse L. Homer requested the name "Homer" but that was rejected and "Joycoy" selected instead. No one has an explanation for the name, but a possible supposition is that perhaps it was a combination of his wife's name and maiden name.

The site of Joycoy is a little over two miles west of Pritchett and on the west side of US 160 at the intersection with Road BB (a mile after US 160 turns to the south). From the site, Pritchett is visible in the distance. No trace of Joycoy remains to mark the site.

Chronology of the Post Office

May 24 1915 ---	SE/4 Sec 10 T31S R49W The suggested name of "Homer" was rejected. 1-1/2 miles north of Lone Rock Creek. Applicant for postmaster - Jesse L. Homer	
Aug 13 1915	Established	
Aug 13 1915	Homer, Jesse L.	
Apr 21 1920	Heness, Leon	
May 6 1920	Lynch, George A. M.	
Oct 7 1921	Cotton, Myrtle M.	Acting
Feb 4 1922	Cotton, Myrtle M.	Appointed
Mar 15 1927	Discontinued Moved to Pritchett	

Confirmed types of postal markings

1	JOYCOY, / COLO. CI 10P 32.0	Nov 29 1915 Aug 16 1918 4bars S-24x19mm
---	--------------------------------	--

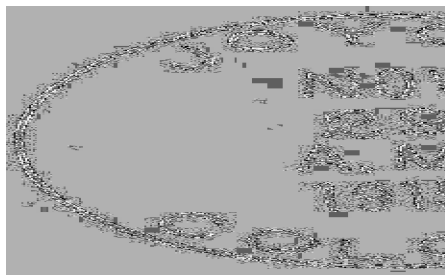

KIRKWELL

This was another rural post office. Even though the office lasted only four years from its establishment in 1917, it remained on maps until sometime in the 1940's. The name appears to derive from the family name of the applicant for postmaster, Mrs. John Kirk and the first postmaster, Anna R. Kirk (probably the same person).

For directions to this post office, see CARRISO. Unfortunately there is nothing of interest remaining at this site.

Chronology of the Post Office

Feb 16 1917	--	SW/4 Sec 28 T33S R49W
		Applicant for postmaster - Mrs. John Kirk
Jun 1 1917		Established
Jun 1 1917		Kirk, Anna R.
Dec 10 1919		Worden, Jay S.
Dec 24 1921		Discontinued Mail to Oklarado

Confirmed types of postal markings

1 **KIRKWELL. / COLO.** Mar 29 1919
 CI 10P 32.0 4bars S-25x20mm



KONANTZ

This rural post office was located near the Colorado-Kansas Border and close to the old Texas Cattle Trail. Although the community was small, it was large enough to warrant construction of another of the WPA Depression Era schools. The Konantz Post Office was originally sited in Kansas, but in 1895 it was moved across the line to a location in Colorado. I have found no information as to the origin of the name. Most likely it honored an early settler or postmaster at the Kansas location.

To reach this site, from Walsh, drive eleven miles east on Road DD to Road 55 and Konantz. There are several buildings in the area although none at the point described in the Geographic Site Location Reports. The school still stands but is boarded up. The border with Kansas is another mile and a half to the east and there is a cemetery just west of the border.

Chronology of the Post Office

Jan 4 1895		Moved from Kansas to Colorado
Jan 4 1895		Bohl, Flora
Mar 12 1895	--	SE/4 Sec 32 T30S R41W The sketch map refers to an "old site Konnantz" as in the center of Sec 26 T30S R41W.
Oct 9 1906		McGowan, Clementina
Aug 19 1911		Florey, Samuel L.
Aug 15 1918		Discontinued Mail to Stonington
Apr 21 1921		Re-established
Apr 21 1921		Case, Thomas L.
Nov 19 1922		Case, Mrs. Thomas L. Acting
Apr 18 1924		Ordered closed
Apr 30 1924		Discontinued Mail to Springfield; Last listed in 1918 Postal Guide

KONANTZ – Continued**Confirmed types of postal markings**

- | | | |
|---|---------------------------------|---|
| 1 | KONANTZ / KAS.
CI 10P 27.0 | Jan 31 1889
Hstp Target, 4-ring |
| 2 | KONANTZ, / COLO.
CI 10P 31.0 | Mar 18 1908 May 18 1914
Doane Type 3 with 1; S-22x13mm |

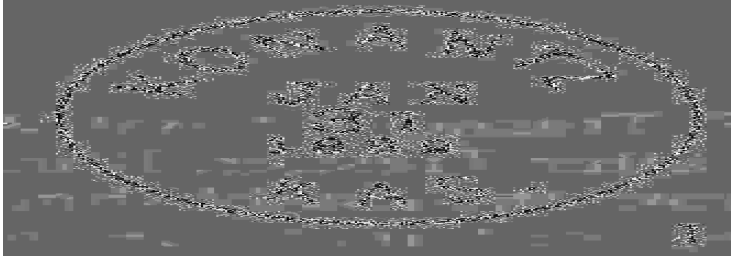

The abandoned school building at Konantz WPA style construction of the 1930's
 Photograph by William H. Bauer May 3, 1998

LAMPORT

Lamport was one more of the rural post offices in Baca County. It is mentioned only briefly in the historical literature and nothing is recorded about its history or the source of the name. However, Francis E. Lamport served as postmaster from 1911 to 1913 and Marie A. Lamport was postmaster from 1913 to 1915 and continued in office briefly as Marie Coulter. Thus, it appears that the name Lamport was a family name, prominent in the area.

LAMPORT – Continued

The site of Lamport is on County Road M, at the intersection with Road 51. The plotted site is on the south side of Road M, but nothing remains there. There are some buildings on the north side of Road M. They are of the proper time period and likely constituted a portion of whatever was the community of Lamport. The simplest access route is to drive south from Walsh on Road 44, sixteen miles and turn east on Road M another six miles to the site of Lamport.

Chronology of the Post Office

Jun 1 1908	---	NE/4 Sec 28 T33S R42W	
		Proposed postmaster - Sam G. Walters	
Jun 8 1908		Established	
Jun 8 1908		Walters, Sam L.	
Feb 7 1911		Lamport, Francis E.	
Oct 28 1913		Lamport, Marie A.	
Mar 24 1915		Coulter, Marie A.	
May 18 1915		Butcher, Mary	
Oct 6 1922		Coulter, Wilford H.	Acting
Oct 7 1922		Coulter, Wilford H.	Appointed
Jan 19 1923		Coulter, Elmer J.	Acting
Feb 21 1923		Coulter, Elmer J.	Appointed
Oct 10 1925		Hindman, Hazel	
May 31 1927		Discontinued Mail to Richards	

Confirmed types of postal markings

1	LAMPORT, / COLO.		Feb 23 1909 Aug 1 1910
	CI 10P 32.0	4bars S-25x14mm	
2	LAMPORT, / COLO.		Dec 14 1914
	CI 10P 32.0	4bars S-??x19mm	

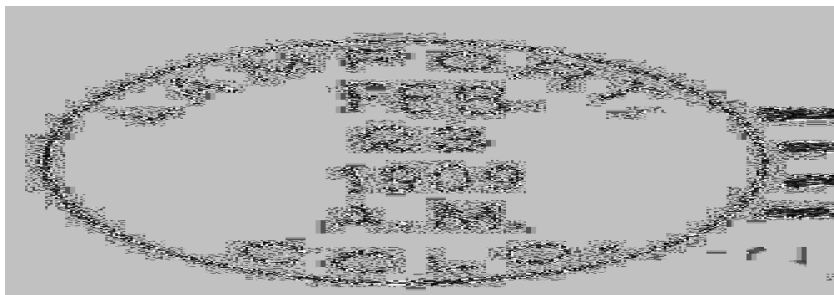

LYCAN

Lycan began in 1920 when Mabel Lycan and her father, Morgan B. F. Tresner a Civil War veteran, took up homesteads in the area. They planned to model the new community after Tresner, Illinois the original home of the Tresner family. Mabel Lycan was the schoolteacher and from the establishment in 1914 until 1952, was the Lycan postmaster. Lycan was a modest community, well into the mid-twentieth century.

Lycan is in the northeastern corner of Baca County. On Colorado Highway 89, drive two miles south of the Baca / Prowers County line to Road VV. Turn west three miles to County Road 49 and the original location of Lycan. There are still a number of buildings around the intersection of Roads 49 and VV, including the old school building that is longer in use.

LYCAN – Continued

In late 1936, the post office was moved to a new location at the junction of Colorado Highways 89 and 116. The move was to a site that would have more traffic and better business opportunities for the store that housed the post office. The post office continued to operate there until 1975. The combination store and service station has been closed for a number of years, but as late as October 1997, the building was still standing, abandoned and decaying.

Latitude = 37:36:55-North Longitude = 102:12:01-West

Chronology of the Post Office

Jun 27 1913	Established	
Jun 27 1913	Lycan, Mabel	Confirmed
Jul 7 1913 ---	SW/4 Sec 18 T28S R42W	
Jul 25 1913	Lycan, Mabel	Commissioned
Aug 19 1913	Lycan, Mabel	Assumed charge
Apr 1 1914 ---	SW/4 Sec 18 T28S R42W 3-1/2 miles north of Buffalo Creek (dry)	
Mar 15 1916 ---	NW/4 Sec 18 T28S R42W An apparent move from the SW/4 Sec 18 to the NW/4 Sec 18 (sketch map)	
	Postmaster - Mabel Lycan	
Dec 7 1933	Henderson, Mrs. Dell	Assumed charge
Dec 18 1933	Henderson, Mrs. Dell	Acting
Nov 4 1935	Henderson, Mrs. Dell	Confirmed
Nov 19 1935	Henderson, Mrs. Dell	Commissioned
Dec 14 1936 ---	NE/4 Sec 3 T29S R42W Local Name "Buckeye Store." A move 5-11/16 miles east and south of a previous location. 1-1/2 miles north of Buffalo Creek.	
	NOTE: "It is a good business place, more convenient to the general public. There is nothing here but the P.O., the house is a wreck, It will increase the business of the office. On better roads, and give the star carrier a good graded road all the way from Holly to Walsh." Postmaster - Dell J. Henderson	
Oct 21 1941 ---	NE/4 Sec 3 T29S R42W At junction of State Highway 89 and US 160. Buffalo Creek 1-1/2 miles south of post office.	
Jul 31 1952	Harlow, Zona L.	Assumed Charge
Aug 8 1952	Harlow, Zona L.	Acting
Jan 8 1953	Harlow, Zona L.	Confirmed
Feb 12 1953	Harlow, Zona L.	Appointment rescinded
Mar 31 1953	Brown, Mrs. Edna Mae	Assumed charge
Apr 21 1953	Brown, Mrs. Edna Mae	Acting
Apr 27 1953	Brown, Mrs. Edna Mae	Confirmed
May 20 1953	Brown, Mrs. Edna Mae	Commissioned
Jul 8 1954	Meek, Mable Rosie	Assumed charge
Aug 17 1954	Meek, Mable Rosie	Acting
Oct 15 1954	Meek, Mable Rosie	Confirmed
Dec 3 1954	Meek, Mable Rosie	Commissioned
Jan 6 1955	Meek, Mable Rosie	Possession
Feb 21 1957	Claunch, Henry Moore	Assumed charge
Feb 26 1957	Claunch, Henry Moore	Acting
Apr 19 1957	Claunch, Henry Moore	Appointed
Jun 29 1957	Claunch, Gloria N.	Officer in Charge
Mar 29 1974	Dickerson, Ramona L.	Non-Postal officer in charge
Sep 12 1975	Discontinued Mail to Two Buttes	

Confirmed types of postal markings

1	LYCAN, / COLO. CI 10P 32.0	4bars S-25x20mm	Oct 30 1914 Jan 13 1915
2	LYCAN / COLO. CI 10P 32.0	4bars S-23x14mm	Feb 13 1928 Oct 17 1938

LYCAN – Continued

3	LYCAN / COLO. CI 10P 29.0	Dplx Grid, 9-bar oval	Feb 12 1938	Apr 6 1939
4	LYCAN / COLO. CI 10P 33.0	4bars S-24x18mm	Dec 20 1940	Aug 26 1946
5	LYCAN / COLO. CI 10P 34.0	4bars S-25x20mm	Nov 10 1950	Jan 3 1955
6	LYCAN / COLO. CI 10P 33.0	4bars S-25x20mm	Apr 24 1958	Sep 22 1964
7	LYCAN, CO / 81056 CI 10P 32.0	4bars S-23x19mm, narrow spaced letters	Nov 10 1965	Nov 13 1973
8	LYCAN, CO / 81056 CI 10P 31.0	4bars S-24x18mm, wide spaced letters	Jun 20 1975	Sep 12 1975



The final location of the Lycan Post Office
Photograph by James L. Ozment October 4, 1997

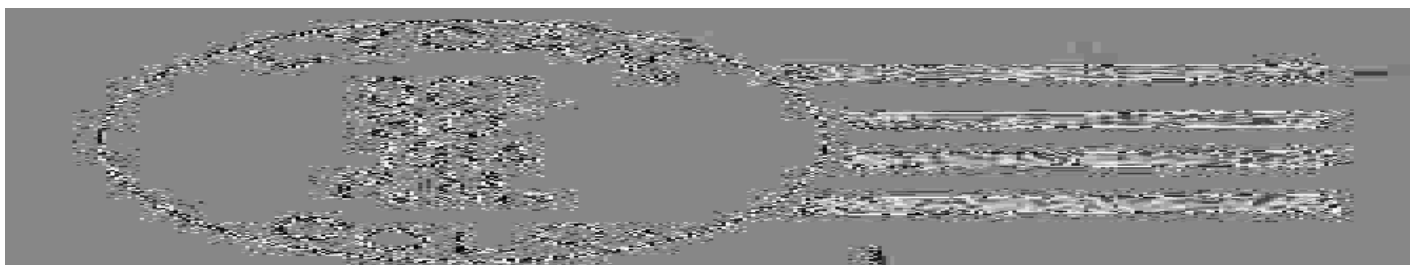

LYCAN – Continued

**MAXEY**

Maxey was a rural post office on the wagon road from Springfield to Atlanta. There was a small country store and a few houses, but the drought of the 1890's ended the boom in the area.

For Maxey, two sites were reported to the Post Office Department. From US 160 at Pritchett, drive 8 miles north on County Road 12 to County Road MM. Turn east for three miles to County Road 15, then turn south one mile. The second location of Maxey was at this point, to the west of the road. There are still some ranch buildings at this location. The first location was another mile south and on the east side of the road, but a fence blocks access to the site; from the fence it appears to be an empty field.

Latitude = 37:35:37-North Longitude = 102:51:39-West MAXEY CEMETERY & CHURCH

Chronology of the Post Office

Jan 3 1889	---	SW/4 Sec 34 T29S R48W Also known as "Interstate." 1/4 mile north of the North Fork of Bear Creek. Proposed postmaster - Asa M. Steele
Jan 19 1889		Established
Jan 19 1889		Steele [Stule?], Asa M.
Oct 9 1894		Discontinued Papers to Springfield
Jun 6 1895		Re-established
Jun 6 1895		Davis, Alice M.
Feb 20 1896	---	NE/4 Sec 33 T29S R48W 3/4 mile north of Plum Creek. Proposed postmaster - Alice Marsh Davis
Jul 21 1908		Ammann, Herman
Oct 28 1913		Ammann, Jennie
Apr 19 1915		Ammann, Herman
Jul 31 1920		Discontinued Mail to Deora

Confirmed types of postal markings

1	MAXEY / COLO. CI 10P 28.0	Mar 6 1909 Mar 27 1909 Hstp Target, 4-ring 17mm
2	MAXEY, / COLO. CI 10P 31.0	Dec 29 1914 Feb 15 1919 4bars S-24x19mm

MAXEY – Continued

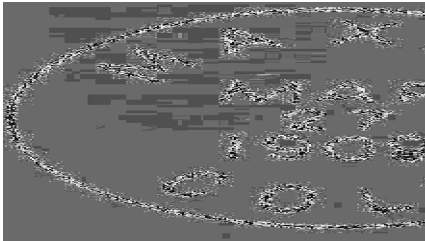

MINNEAPOLIS

The original settlement in the area took the name of “Butte City”; however that did not last for more than a few weeks and when a post office was first established it was named “Corinth.” In August 1887 the Corinth post office moved, or changed its name to Minneapolis. However, Judge Hines first entered the Minneapolis town site in 1887 and a town plat was filed for Minneapolis on February 11, 1888. The Minneapolis post office remained active until November 1899. In May 1900, there may have been intent to re-establish the Minneapolis office at a new, nearby location, but when that post office opened in May, it was given the name “Blaine.”

For at least two years Minneapolis was an important town in the southern portion of Baca County. It continued as a commercial and supply center for surrounding ranches and farms even through the drought of the 1890’s but eventually died out as other towns gained in importance.

The name is believed to have originated with a group of settlers who came to Baca County from Minnesota. It was in keeping with other “big city” town names in the region: Boston, Atlanta and Springfield.

Minneapolis was located just east of the junction of County Roads MM and 40. The Minneapolis cemetery is at that intersection and is a landmark for this ghost community. In addition to the cemetery, there are ruins of two old stone buildings at the site. A visit to Minneapolis will also include the sites of Corinth and Blaine. To reach this location, refer to the directions to Corinth.

Latitude = 37:29:58-North Longitude = 102:15:15-West MINNEAPOLIS CEMETERY

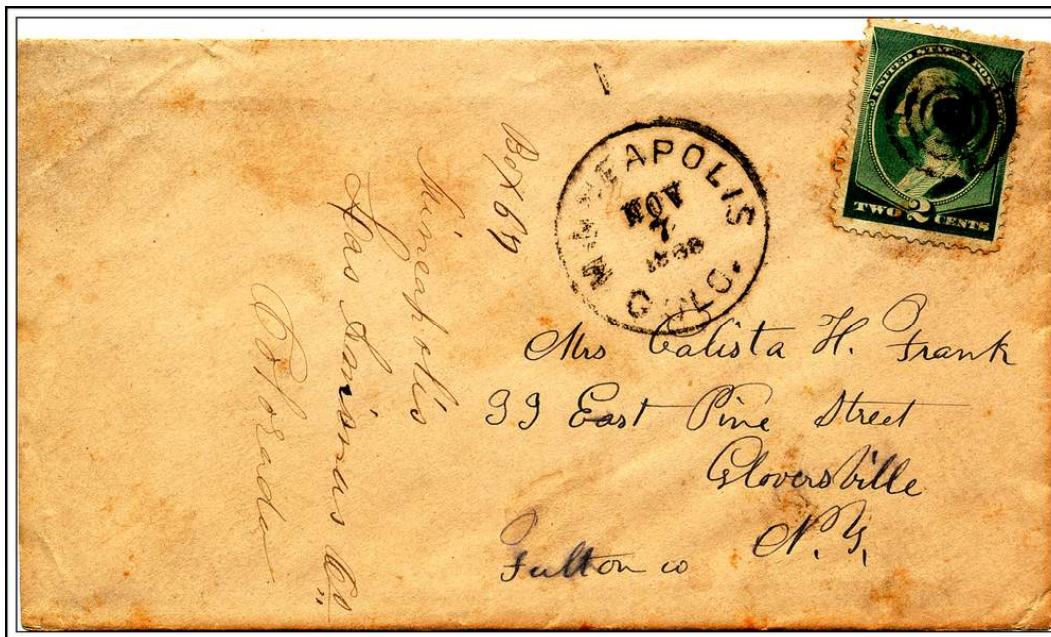

MINNEAPOLIS / COLO. November 7, 1888

MINNEAPOLIS – Continued
Chronology of the Post Office

Nov 22 1882 --- NW/4 Sec 26 T29S R43W 1 mile north of Horse & Bear Creek.
Proposed postmaster - Wallace B. McNeil [McNeel?]

Aug 12 1887 Moved from Corinth
Aug 12 1887 McNeil[McNeel?], Wallace B.
Dec 22 1888 Jones, Harry F.
Nov 29 1889 Myers, Madison M.
Apr 25 1895 Smith, Olive P.
Nov 11 1895 Herbert, Mary
Jul 21 1899 Brooks, Lewis
Nov 15 1899 Discontinued Mail to Springfield

Confirmed types of postal markings

- | | | | |
|---|-------------------------------------|--------------------------|------------------------|
| 1 | MINNEAPOLIS, / COLO.
CI 10P 26.5 | Hstp Cork, smudge | Mar 3 1888 Jun 4 1888 |
| 2 | MINNEAPOLIS / COLO.
CI 10P 27.5 | Hstp Target, 4-ring 17mm | Jul 23 1888 Feb 3 1899 |



The cemetery near the sites of Minneapolis, Colorado
Photograph by James L. Ozment October 4, 1997

MONON

Monon was a rural post office near the border with Kansas. The post office was moved two and one-half miles west from its original location in Stanton County, Kansas. There may have been a small community here, but more likely it was at the ranch or farm home of a person who was willing to assume the responsibility of postmaster and to serve their neighbors.

From the Kansas-Colorado border, drive west on US 160 about three-quarters of a mile. Turn north and cross the railroad tracks. Monon was about 300 yards north of the railroad and in 1997 there were still some old abandoned buildings at the site.

Chronology of the Post Office

- Nov 1 1901 -- Moved 2-1/2 miles west from Stanton County Kansas, into Baca County Colorado
- Nov 1 1901 Post Office moved from Kansas
- Nov 1 1901 Johnston, Lucinda B.
- Jan 4 1902 --- NE/4 Sec 5 T30S R41W
- Apr 15 1918 Discontinued Mail to Konantz

Confirmed types of postal markings

- | | | | |
|---|-------------------------------|--------------------------------|------------------------|
| 1 | MONON / COLO.
CI 10P 29.0 | Hstp Not present | Jul 26 1902 |
| 2 | MONON, / COLO.
CI 10P 31.0 | Doane type 3 with 1, S-22x14mm | Jul 8 1908 Jan 27 1913 |
| 3 | MONON / COLO.
CI 10P 32.0 | 4bars S-25x19mm | Jun 1 1914 Jul 29 1915 |



1

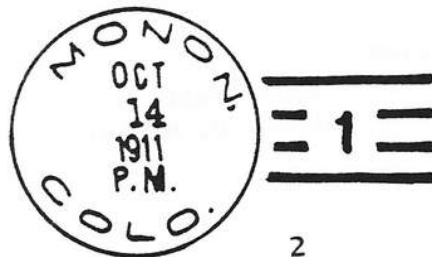

2

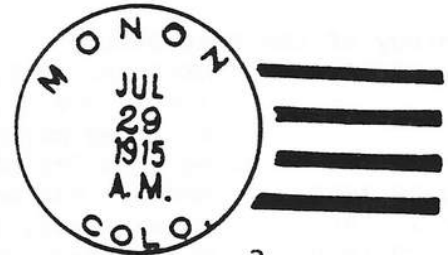

3

NOWLINSVILLE

Nowlinsville was a short-lived rural post office southwest of Campo. "Lura" was the name requested for the post office, but that was rejected and the family name of the postmaster, Minnie Lee Nowlin, was altered for use.

To reach this site, drive four miles west from Campo on Road J to Road 24. Turn south five miles to Road D, then one mile west. Walking about 20 feet south from the road, you should find a building foundation, the last remnant of Nowlinsville.

Chronology of the Post Office

- Dec 22 1915 --- NW/4 Sec 1 T35S R47W The suggested name "Lura" was rejected.
Applicant for postmaster – Mrs. Minnie Lee Nowlin
- May 29 1916 Established
- May 29 1916 Nowlin, Minnie L.
- Jun 14 1919 Discontinued Mail to Campo

Confirmed types of postal markings

- | | | | |
|---|--------------------------------------|-----------------|------------|
| 1 | NOWLINSVILLE, / COLO.
CI 10P 33.0 | 4bars S-??x20mm | Oct 3 1916 |
|---|--------------------------------------|-----------------|------------|

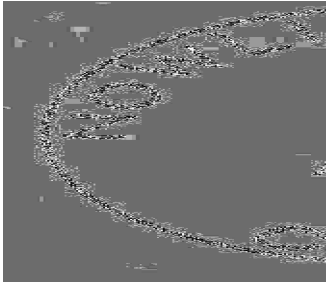
NOWLINSVILLE – Continued**OKLARADO**

From the information contained in the Post Office Department Geographic Site Location Reports it seems that there was more than one ranch at or near this location. However, it was never an organized community. The requested name “Verl” was not accepted and the name “Oklarado” was chosen, reflecting the location not far from the Oklahoma-Colorado border.

For directions to this post office, see CARRISO.

All that remains are a couple of trees and a few pieces of scrap metal on the west side of Road 8.

Chronology of the Post Office

Dec 18 1915	---	SE/4 sec 29 T32S R49W The suggested name "Verl" was rejected. Applicant for postmaster - Gertrude Crawford
May 12 1916		Established
May 12 1916		Crawford, Gertrude
May 31 1921		Gibbons, Hettie
Apr 7 1922	---	NE/4 Sec 32 T32S R49W A move 200 yards south of a previous location. (By sketch map, from SE/4 Sec 29)
June 5 1935		Order closed
Jun 29 1935		Discontinued Mail to Utleyville
Jul 18 1935		Modified Mail to Springfield

Confirmed types of postal markings

1	OKLARADO / COLO. CI 10P 33.0	Apr 9 1917 Jun 29 1935	4bars S-24x20mm
---	---------------------------------	------------------------	-----------------

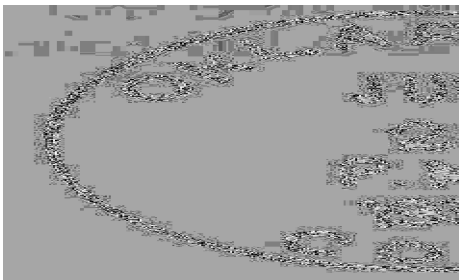
**ONINE**

Onine was a rural post office near the northwestern boundary of Baca County. The local name for the chosen site was the “Onine Ranch.” I suspect that the name is likely a verbalization of the ranch’s brand: “O 9.”

I was not able to get to the site of Onine. It was located about three miles north of County Road PP and there was no apparent access from any road.

ONINE – Continued

Chronology of the Post Office

Dec 30 1917 --- SE/4 Sec 30 T28S R50W 1/4 mile east of Rule Creek, 3/4 mile east of the County Line. Local name - Onine Ranch.
Applicant for postmaster - Polly A. Wier

Jun 6 1918 Established
Jun 6 1918 Wier, Polly A.
Apr 24 1920 Welty, Daisy
Jun 1 1921 Ordered closed
Jun 30 1921 Discontinued Mail to Deora

Confirmed types of postal markings

1 ONINE, / COLO. May 9 1921
CI 10P 32.0 4bars S-24x20mm



PRIDE

Pride was another ranch post office in the southeastern corner of Baca County. The suggested name of “Wadkins” was rejected. The name Pride may represent just that - pride in the ranch or settlement.

To reach Pride, drive south from Campo on US 287 / 385 to County Road C. Turn east twelve and one-half miles to Road 42 and one mile south to Road B. Pride is described as in the northwest corner of this intersection but there is no sign of its having been there. However, by turning west on Road B and driving a half-mile, you come to an old ranch that was certainly served by the Pride post office.

Chronology of the Post Office

Jul 11 1914 --- SE/4 Sec 7 T35S R43W The suggested name "Wadkins" was rejected.
Applicant for postmaster - Mrs. Maude E. Good

Dec 18 1914 Established
Dec 18 1914 Good, Maude F.
Nov 16 1916 Rogers, Flora L.
Mar 4 1918 Glover, Effie
Jun 15 1920 Discontinued Mail to Campo

Confirmed types of postal markings

1 PRIDE, / COLO. Aug 19 1915
CI 10P 32.0 4bars S-25x20mm

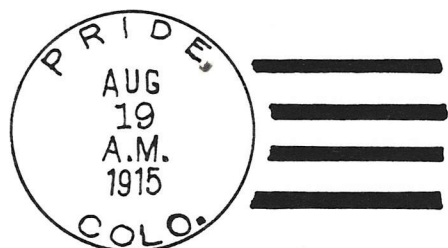

PRIDE – Continued

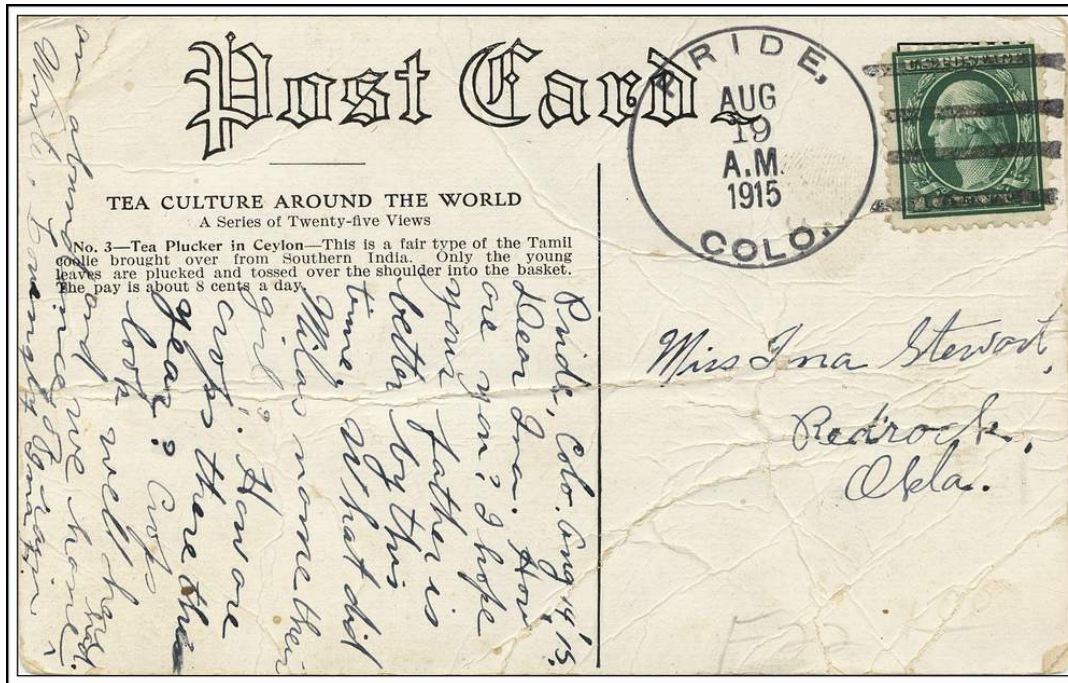

PRIDE, / COLO.

August 19, 1915

PRITCHETT

Pritchett is the western terminus of a branch of the Atchison, Topeka and Santa Fe Railroad, (the Dodge City and Cimarron Valley Railroad) and was named for Dr. Henry S. Pritchett, a director of the railroad. The railroad was completed to the site of Pritchett in 1926 and J. H. Keefe filed the town plat on November 23, 1926. The first settlement in the area was at Joycoy, three miles to the west-southwest. However, when the railroad chose not to build further west, Joycoy folded and moved to Pritchett at the end of track.

Pritchett was the center for a dry-farming and dairying district and continues in that roll, however, to a lesser extent than in the past.

The community of Pritchett is on US 160, twelve miles east of the Las Animas County line.

Latitude = 37:22:13-North Longitude = 102:51:33-West

Chronology of the Post Office

The following two entries refer to Joycoy, not to Pritchett

- May 24 1915 --- SE/4 Sec 10 T31S R49W The suggested name "Homer" was rejected. 1-1/2 miles north of Lone Rock Creek. Applicant for postmaster - Jesse L. Homer
- Feb 4 1922 Cotton, Myrtle M.
- Mar 15 1927 Moved from Joycoy
- May 4 1929 --- NE/4 Sec 7 T30S[sic] R41W 400 OR 500 feet north of the Santa Fe Railroad.
- May 6 1929 Dougan, James H. Acting
- Jul 1 1929 Dougan, James H. Presidential
- Apr 16 1930 Oyler, Gwendolyn
- Oct 12 1932 --- SE/4 Sec 6 T31S R48W 350 feet north of the Santa Fe Railroad.
- Jul 14 1934 Stuart, James W. Acting
- Aug 1 1934 Stuart, James W. Assumed charge
- Jan 10 1935 Stuart, James W. Nominated

PRITCHETT – Continued

Jan 21 1935	Stuart, James W.	Confirmed
Feb 19 1935	Stuart, James W.	Commissioned
Jun 22 1939	Stuart, James W.	Nominated
Jul 5 1939	Stuart, James W.	Confirmed
Jul 12 1939	Stuart, James W.	Appointed Presidential
Aug 22 1939	Stuart, James W.	Commissioned
Oct 23 1941 ---	SE/4 Sec 6 T31S R48W US highway 160	goes along in front of the post office.
Feb 4 1947	Stuart, Ruth Odean	Acting
Feb 5 1947	Stuart, Ruth Odean	Assumed charge
Sep 11 1950	Stuart, James	Nominated
Sep 15 1950	Stuart, James	Confirmed
Sep 20 1950	Stuart, James	Appointed Presidential & Commissioned
Oct 31 1950	Stuart, James	Assumed Charge
Jun 26 1959	Shelton, Ertis D.	Assumed charge
Jul 6 1959	Shelton, Ertis D.	Acting
Apr 27 1960	Shelton, Ertis D.	Nominated
Jun 21 1960	Shelton, Ertis D.	Confirmed
Jun 27 1960	Shelton, Ertis D.	Appointed Presidential & Commissioned

Confirmed types of postal markings

1	PRITCHETT / COLO. CI 10P 27.0	Feb 16 1933 Aug 10 1935
1.1	PRITCHETT, / COLO. RC 10P 37.0x15.0	Dplx Grid, Oval with 1 1950s Hstp No killer, Parcel Post Box style [NOT AVAILABLE FOR ILLUSTRATION]
2	PRITCHETT / COLO. CI 10P 30.0	Aug 10 1938 Dec 26 1962
2.1	PRITCHETT, COLO. / REGISTERED CI 11P 28.0/18.0	Dplx Grid, oval with 1 Feb 9 1944
2.2	PRITCHETT, COLO. / M.O.B. CI 11P 28.0/18.0	Hstp No Killer Feb 9 1944
3	PRITCHETT, COLO / USPO CI 11P 30.0/19.0	Hstp No killer Aug 5 1968
4	PRITCHETT, CO / 81064 CI 10P 32.0	4bars S-24x20mm Aug 25 1969 Jan 16 1973
5	PRITCHETT, CO / 81064 CI 10P 33.0	4bars S-25x19mm May 31 1975 Oct 5 1977
6	PRITCHETT, CO / 81064 CI 10P 34.0	4bars S-25x21mm Oct 9 1987 Apr 15 1988
7	PRITCHETT, CO / 81064 CI 10P 32.0	4bars S-24x18mm Jul 10 1989 Oct 3 1997



PRITCHETT – Continued

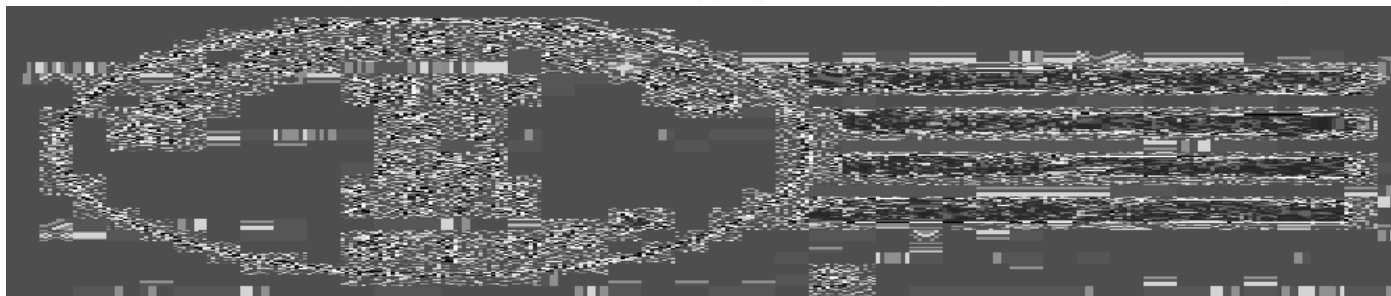
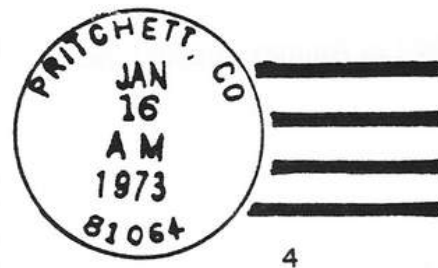

PROGRESS

Progress was a rural post office located on the road from Kansas to Stonington. One historical reference connects Progress to a town promotion to be known as Plymouth. This connection is confirmed by the Geographic Site Location Report that initially requested the name of “Plymouth,” but that choice was rejected by the Post Office department. Progress is another of the many towns that were established in the late 1880’s and disappeared during the dry period of the 1890’s.

Begin at Stonington and drive south two miles on County Road 49. Turn east on Road V. The site of Progress was in the next half-mile, but nothing remains to mark its location.

Chronology of the Post Office

- Apr 23 1888 --- S/2 SE/4 Sec 8 T32S R42W The suggested name "Plymouth" was rejected.
Proposed postmaster - William H. Walker
- Sep 26 1888 Established
- Sep 26 1888 Walker, William R.
- Feb 28 1890 Snyder, William
- Nov 13 1894 Snyder, Maggie E.
- Nov 19 1895 Discontinued Mail to Stonington

Confirmed types of postal markings

1 PROGRESS / COLO.
CI 10P 27.0

Dec 16 1889 Mar 27 1893
Hstp Not present (Year date is questionable)



REGNIER

Regnier was a ranch post office located a very short distance north of the Colorado-Oklahoma border. It was no longer listed under Colorado in the post 1920 *Postal Guides*, but a Regnier does then appear under Oklahoma.

The source of the name appears to be that of the first postmaster; Carrie Regnier and was most likely at her home.

From Pritchett, drive south on County Road 13 to the Colorado-Oklahoma border. Regnier was a quarter mile north of the border, on the east side of Gallienas Creek, in an open area along that stream. No evidence of Regnier is readily visible. In early 1920 Charles A. Kirtley was appointed postmaster for Regnier and it is likely that this is when the office moved south into Oklahoma.

Chronology of the Post Office

- May 31 1900 --- NW/4 Sec 17 T35S R48W A few rods east of Gallinas Creek.
Proposed postmaster - Carrie Regnier
Postmaster - Carrie Regnier
- Sep 25 1900 Established
- Sep 25 1900 Regnier, Carrie
- Feb 25 1914 --- NE/4 NW/4 Sec 17 T35S R48W 1/4 mile north of the county boundary.
On the east bank of Gallienas Creek.
- Feb 27 1920 Kirtley, Charles A.
- ???? A new postmaster was appointed on Feb 20, 1920, but the office is not listed under Colorado in the 1920 or later postal guides. However, a Regnier is listed under the state of Oklahoma.

Confirmed types of postal markings

- 0.1 REGNIER, / COLO. May 1 1909 June 21 1909
CI 10P ????
 - 1 REGNIER. / COLO. Dec 7 1908 Jul 26 1919
CI 10P 32.0
- Doane Type 3 with 1
[NOT AVAILABLE FOR ILLUSTRATION]
4bars s-23x19mm

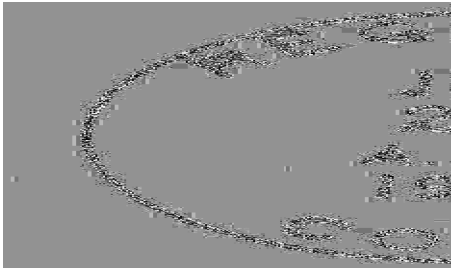

RICHARDS

In 1911, a man named Lewis J. Richards, his wife and their son Dean moved from Oklahoma to a site near the South Fork of the Cimarron River. They opened a store and obtained a post office that was given their family name. The settlement grew to include a cream and egg station, a blacksmith shop and at least six residences. The Richards post office operated until 1938, but in 1998 only a concrete slab and some concrete rubble remained to mark the plotted site in the southwest corner of the intersection of Roads 42 and N. At that time there were still some small buildings on the northwest corner of the intersection that were undoubtedly a part of Richards.

From Walsh, drive south on County Road 44 fifteen miles to County Road N, then west two miles to Road 42. The site is in an open field.

Continue west another six and a half miles to Road 36 and the 1927 location of Rodley.

RICHARDS – Continued**Chronology of the Post Office**

Jan 7 1911	---	NE/4 Sec 24 T33S R44W	
		Proposed postmaster - Lewis J. Richards	
Jan 27 1912		Established	
Jan 27 1912		Richards, Lewis J.	
Feb 26 1914	---	NE/4 Sec 24 T33S R44W	
		Postmaster - Lewis J. Richards	
Oct 15 1915		McClendon, Marion U.	
Apr 10 1919		Murphy, Peter R.	
Dec 19 1921		Thomas, George J.	
Jun 30 1922		Campbell, Edna	
Jul 7 1927		Bechtle, Ralph E.	Confirmed
Jul 25 1927		Bechtle, Ralph E.	Commissioned
Aug 1 1927		Bechtle, Ralph E.	Assumed charge
Jan 1 1938		Ordered closed	
Feb 28 1938		Discontinued Mail to Campo	

Confirmed types of postal markings

1	RICHARDS, / COLO		Apr 15 1912	May 22 1928
	CI 10P 32.0	4bars S-24x19mm		
2	RICHARDS, / COLO.		Oct 29 1929	Jun 2 1934
	CI 10P 33.0	4bars S-25x20mm		
3	RICHARDS / COLO.		Feb 28 1938	
	CI 10P 33.0	4bars S-??x18mm		

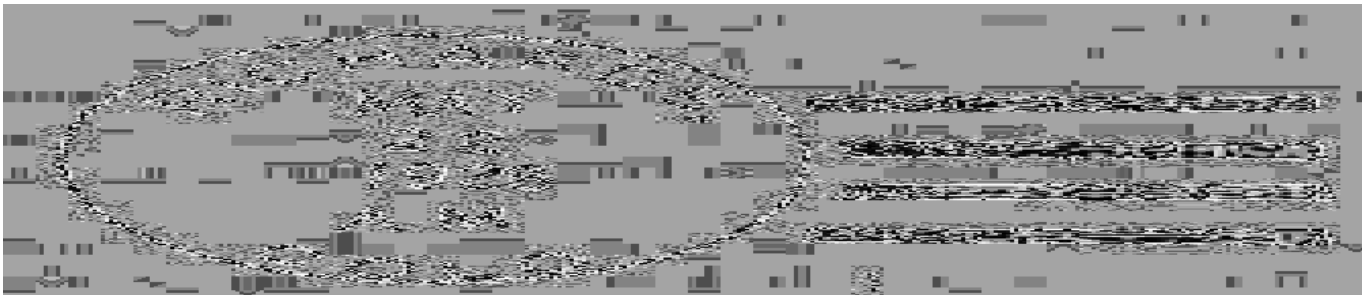
**RODLEY**

Rodley was a rural post office on the road from Vilas to Campo.

To reach the site of Rodley, drive south from Vilas on County Road 36. At nine miles there is a short jog in the road to the east. After the road again turns south, continue 5 miles to the reported 1927 site of Rodley at Road N. At this location there is a fenced off water tank, some trees and rubble.

From the 1927 site on Road 36, go back north one mile to Road P and turn west. Go two miles to Road 34 and then north one mile to Road Q. This was the original site (1910) of the Rodley post office, but nothing remains. It is plowed fields and grassland.

Latitude = 37:11:28-North Longitude = 102:29:08-West RODLEY CEMETERY

Chronology of the Post Office

Mar 22 1910	---	NE/4 Sec 10 T33S R45W	
		Proposed postmaster - Jennie Francis Islieb	
May 21 1910		Established	
May 21 1910		Islieb, Jennie F.	
Nov 2 1911		Jones, Claude T.	
Jan 18 1915		Ballou, George N.	

RODLEY – Continued

Jul 23 1917	---	SE/4 Sec 10 T33S R45W	A move 1-1/2 miles north east of a previous location. By the sketch map, from the NW/4 SW/4 Sec 15 T33S R45W.
Jul 27 1917			Butler, Harry A.
May 6 1927	---	SE/4 Sec 13 T33S R45W	A move 2 miles east and 1-3/5 miles south of a previous location.
Jun 16 1927		Davis, Stella G.	Acting
Sep 8 1927		Davis, Stella G.	Appointed
Sep 16 1937		Ordered closed	
Sep 30 1937		Discontinued	Mail to Richards

Confirmed types of postal markings

1	RODLEY, / COLO. CI 10P 31.0	4bars S-24x19mm	Nov 17 1915	Feb 17 1917
2	RODLEY / COLO. CI 10P 31.0	4bars S-??x19mm	Apr 24 1932	
3	RODLEY / COLO. CI 10P 33.0	4bars S-24x19mm	Sep 30 1937	



RUFF

Ruff was a rural post office on the road from Progress south to Oklahoma. An 1897 map shows a place named “Viena” at the same location later known as Ruff. Benjamin Lamport filed the application for a post office at this location to be called “Cristen.” The name Cristen was rejected in favor of Ruff, however I have no information on the origin of either name. I can speculate that there was some relationship between Benjamin Lamport at Ruff and Francis E. Lamport who was the first postmaster at Lamport, which was a short distance south of the two sites of Ruff.

From Stonington, drive 9 miles south to Road N. At this point there is a track along the section line. In 1998 I was able to drive along this about a half-mile to the east, which still left me short of the site of Ruff. From the end of the track, I could see some trees on a slightly elevated piece of ground. I would guess that was the 1889 site of Ruff. One mile south, at Road M, the intersection with Road 49 was once known as “Midway,” but never had a post office.

The 1892 site of Ruff was two miles east-northeast, on the east side of Road 52. You have two choices: Backtrack two miles to Road Q, turn east for 3 miles to Road 52, then south one mile; or, go south one mile to Road M, then east three miles to Road 52 and north 2 miles to the site. Unless you are a truly dedicated postal historian, you may wish to forgo this junket as the only thing there is a row of older trees.

Chronology of the Post Office

Jun 6 1889	---	SE/4 Sec 17 T33S R42W	The suggested name "Cristen" was rejected. Proposed postmaster - Benjamin Lamport (See LAMPOR ?)
Sep 16 1889		Established	
Sep 16 1889		Lamport, Benjamin	

RUFF – Continued

Dec 10 1891 Pearsons, Thomas J.
Feb 2 1892 --- NW/4 Sec 14 T33S R42W
May 23 1894 Yowell, Sallie E.
Aug 28 1894 Stewart, Mary A.
May 18 1896 Discontinued Mail to Taloga, Kansas



RUFF / COLO. February 9, 1894

Confirmed types of postal markings

1 RUFF / COLO. Oct 18 1890 Feb 14 1894
 CI 10P 27.0 Hstp Target, 4 ring 16mm

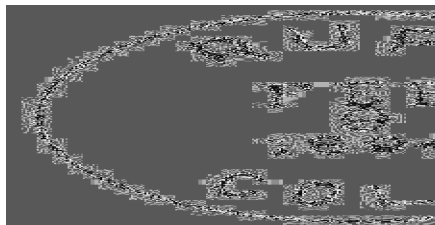

SAND ARROYO

This was a short-lived rural post office named for the nearby Sand Arroyo. I have not found any additional information relative to the settlement.

Sand Arroyo is another site to which I was not able to drive to. My attempt to reach the site began at the intersection of County Roads S and 20. I drove east two miles but there was no road that would take me the mile north to the Sand Arroyo site. From Road S there is a clear view for at least a mile, but no sign of anything of interest. Continuing the attempt, I backtracked one mile and then drove a mile north on Road 21. This brought me to the Lone Star 1917 Cemetery, but again there was no way to go east to the Sand Arroyo site. This cemetery was most likely connected to the Sand Arroyo Community. From the Cemetery, drive back west to Road 20, north two miles to Road U, and west three miles to Road 17 and then nine miles north to US 160.

Chronology of the Post Office

Jun 3 1915	---	SE/4 Sec 22 T32S R47W	The suggested name "Tippett" was rejected.
		1-1/2 miles north of Sand Arroyo Creek.	
		Applicant for postmaster - Charles M. Tippett	
Oct 20 1915		Established	
Oct 20 1915		Tippett, Charles M.	
Dec 31 1917		Discontinued	Mail to Springfield

Confirmed types of postal markings

NO POSTAL MARKINGS HAVE BEEN REPORTED FROM SAND ARROYO

SETON

Seton acquired a post office in 1915, but in less than a year the name was changed to Setonsburg. The historical literature makes no mention of this settlement other than to state that it was located southwest of Springfield. It was apparently another of the ranch post offices serving the farmers and ranchers of Baca County.

Seton/Setonsburg was located nine miles south of Pritchett, in the northwest corner of the intersection of Baca County Roads T and 13. There are signs of activity at that location and a quarter mile or so west is a building to which access is blocked by a fence.

Chronology of the Post Office

Mar 9 1915	---	SE/4 Sec 19 T32S R48W	
		Applicant for postmaster - Mrs. Diantha Brown	
Jun 3 1915		Established	
Jun 3 1915		Brown, Diantha	
Jan 22 1916		Name changed to Setonsburg	

Confirmed types of postal markings

1	Seton Colo	Jul 24 1915
	MS	Mscp Pen cancel

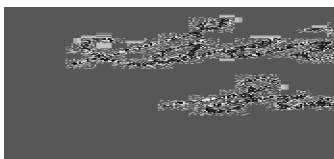

SETONSBURG

For a history and description, please refer to Seton.

Chronology of the Post Office

Jan 22 1916	Formerly named Seton
Jan 22 1916	Brown, Diantha
Jul 31 1919	Ordered closed Mail to Oklarado
Jul 31 1919	Closing order rescinded
May 31 1920	Discontinued

Confirmed types of postal markings

1 SETONSBURG, / COLO.
CI 10P 32.0

Oct 10 1916 Aug 24 1917

4bars S-24x19mm

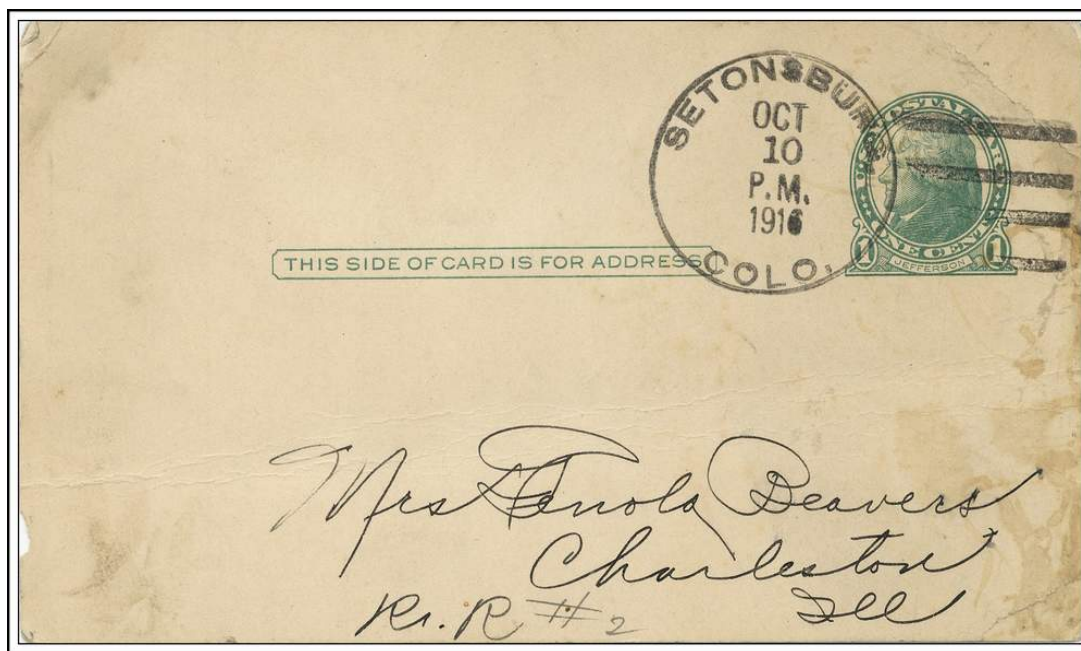
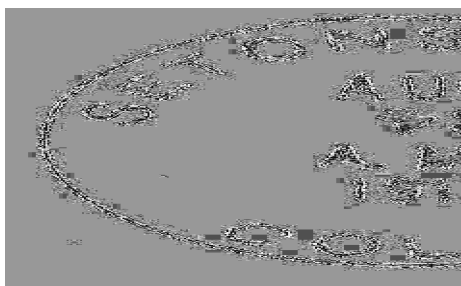

SETONSBURG, / COLO. October 10, 1916

SPRINGFIELD

Springfield is the county seat and the major town of Baca County. It was established in 1887 and incorporated in 1889. The town site promoters came to Baca County from Winfield, Kansas and as the Windsor Town Company purchased a tract of land from Andrew Harrison. The new town was named for Springfield, Missouri, Harrison's hometown. The town site was platted December 18, 1887.

As the county seat, Springfield became the major commercial center for Baca County, a position it continues to hold. In addition, the location at the intersection of two major highways, US 160 and US 287/385, makes it a significant service point for traffic on those roads. Driving east from Trinidad, it is the first town the traveler encounters that can offer more than minimal services.

Latitude = 37:24:30-North Longitude = 102:36:50-West

Chronology of the Post Office

Mar 5 1887	---	NW/4 Sec 29 T30S R46W 2 miles south of Bear Creek. Proposed postmaster - Robert Hague	
Jun 2 1887		Established	
Jun 2 1887		Hogne [Hague?], Robert J.	
Aug 27 1887		Tipton [First name?]	
Jun 14 1889		Anderson, Lloyd A.	
Nov 14 1890		Whitaker, Eugene M.	
Oct 26 1893		Wickoff, Ella R.	
Dec 4 1897		Matthews, Frederick R.	
Dec 27 1898		Hay, Clara M.	
Nov 19 1900		Heckman, Silas E.	
Oct 17 1913		Speckmann, Novellic V.	
Feb 25 1914	---	NW/4 Sec 29 T30S R46W About 3/4 miles north of Cat Creek.	
Apr 7 1915		Gordon, James E.	
Jun 27 1916		Gordon, James E.	P&S
Jul 1 1916			Office made Presidential
Mar 16 1917		Cassaday, R. O.	P&S
Nov 25 1918		Cassaday, Anna B.	Acting
Aug 5 1919		Cassaday, Anna B.	P&S
Feb 9 1920		Ballard, Elmer E.	
Apr 5 1920		Mordica, Cora B.	P&S
Apr 25 1921		Hagerman, Albert A.	Acting
Nov 8 1921		Hagerman, Albert A.	Appointed
Apr 1 1925		Hodges, Roy	Acting
Feb 4 1926		Hodges, Roy	Appointed
Feb 6 1930		Hodges, Roy	Appointed
Apr 20 1934		Davis, Herman H.	Acting
May 1 1934		Davis, Herman H.	Assumed charge
May 4 1934		Davis, Herman H.	Nominated
May 12 1934		Davis, Herman H.	Confirmed
Jun 28 1934		Davis, Herman H.	Commissioned
Apr 29 1938		Davis, Herman H.	Nominated
Jun 13 1938		Davis, Herman H.	Confirmed
Jun 23 1938		Davis, Herman H.	Appointed Presidential
Jul 27 1938		Davis, Herman H.	Commissioned
Mar 15 1941		Finch, Lester V.	Acting
Mar 15 1941		Finch, V. Lester	Acting
Mar 16 1941		Finch, V. Lester	Assumed charge
Oct 2 1941	---	SW/4 NW/4 Sec 29 T30S R46W	
Mar 3 1944		Finch, V. Lester	Nominated
Mar 14 1944		Finch, V. Lester	Confirmed
Mar 15 1944		Finch, Lester V.	Appointed Presidential & Commissioned
May 31 1944		Finch, Lester V.	Assumed charge

SPRINGFIELD – Continued

Jun 3 1946	Finch, Netta May	Acting
Jun 4 1946	Finch, Netta May	Assumed charge
Jan 20 1948	Finch, Netta May	Nominated
Jun 15 1948	Finch, Netta May	Confirmed
Jun 16 1948	Finch, Netta May	Appointed Presidential & Commissioned
Sep 30 1948	Finch, Netta May	Assumed charge
Feb 22 1951	Cook, Leland Y.	Assumed charge
Mar 12 1951	Cook, Leland Y.	Acting
Sep 14 1951	Cook, Leland Y.	Nominated
Sep 26 1951	Cook, Leland Y.	Confirmed
Sep 27 1951	Cook, Leland Y.	Appointed Presidential & Commissioned
Dec 31 1951	Cook, Leland Y.	Assumed charge
Feb 22 1957	Cox, Ben H.	Assumed charge
Feb 26 1957	Cox, Ben H.	Acting
Aug 2 1957	Cox, Ben H.	Nominated
Aug 29 1957	Cox, Ben H.	Confirmed
Sep 6 1957	Cox, Ben H.	Appointed Presidential & Commissioned
Oct 4 1957	Cox, Ben H.	Assumed charge
Jun 27 1972	Smith, Joe T.	Officer in charge
Oct 24 1972	Hartman, Charles D.	Officer in charge
Nov 25 1972	Davis, Ralph W.	Appointed
Jun 7 1975	Myers, Jack	Officer in charge
Nov 22 1975	Shumate, Bennie F.	Appointed
Jan 21 1981	Martinez, Lou	Officer in charge

Confirmed types of postal markings

1	SPRINGFIELD / COLO. CI 10P 27.0	Mar 7 1888 Sep 15 1897 Hstp Target, 18mm
2	SPRINGFIELD, / COLO. CI 10P 29.0	Jan 24 1905 Apr 24 1908 Doane Type 2 with 3; S-??x13mm
3	SPRINGFIELD, COLO. / REC'D. CI 10P 31.5	Jul 8 1912 May 12 1913 Hstp Not present (Did it have any ??)
4	SPRINGFIELD, / COLO. CI 10P 31.0	May 4 1910 Jan 6 1915 4bars S-25x14mm
5	SPRINGFIELD / COLO. CI 10P 30.0	Apr 18 1916 Dplx Not present, probably Grid, 9-bar oval
6	SPRINGFIELD / COLO. CI 10P 20.0	Jun 4 1932 Dec 4 1962 Mach 6 wavy lines
7	SPRINGFIELD / COLO. RC 10P 36.0x20.0	??? ?? 193-? Hstp No killer, Parcel Post Box style
8	SPRINGFIELD / COLO. CI 10P 29.0	Aug 15 1935 Dplx Grid, 9-bar oval
8.1	SPRINGFIELD, / COLO. RC 10P 34.0x17.0	1950s Hstp No killer, Parcel Post Box style
9	Springfield / COLO. RC 10P 38.0x18.0	??? ?? 194- Hstp No killer, Parcel Post Box style
10	SPRINGFIELD / COLO. CI 10P 20.0	Mar 15 1959 Nov 19 1959 Mach Slogan: COLORADO / RUSH TO THE ROCKIES / 1859 CENTENNIAL 1959
11	SPRINGFIELD / COLO. CI 10P 30.0	Nov 13 1963 Dplx Grid, pointed with 1
12	SPRINGFIELD, CO / 81073 CI 10P 31.0	May 30 1975 4bars S-23x18mm
13	SPRINGFIELD, CO 81073 CI 11P 32.0/23.0	Dec 10 1975 Rolr 7 wavy lines

SPRINGFIELD – Continued

14 SPRINGFIELD, CO / 81073
CI 10P 20.0

Mar 16 1966 May 21 1993
Mach 6 wavy lines

15 SPRINGFIELD, CO / 81073
CI 10P 20.0

Dec 1 1986 Apr 13 1987
Mach Slogan in box w/bars; SPRINGFIELD, COLORADO /
THE FIRST 100 YEARS / JULY 1887 TO 1987

16 SPRINGFIELD, CO 81073 / USPS
CI 11P 27.0/18.0

Apr 13 1993
Hstp No killer

17 SPRINGFIELD CO / 81073
CI 10P 31.0

Jun 8 2000
4bars S-13x23mm

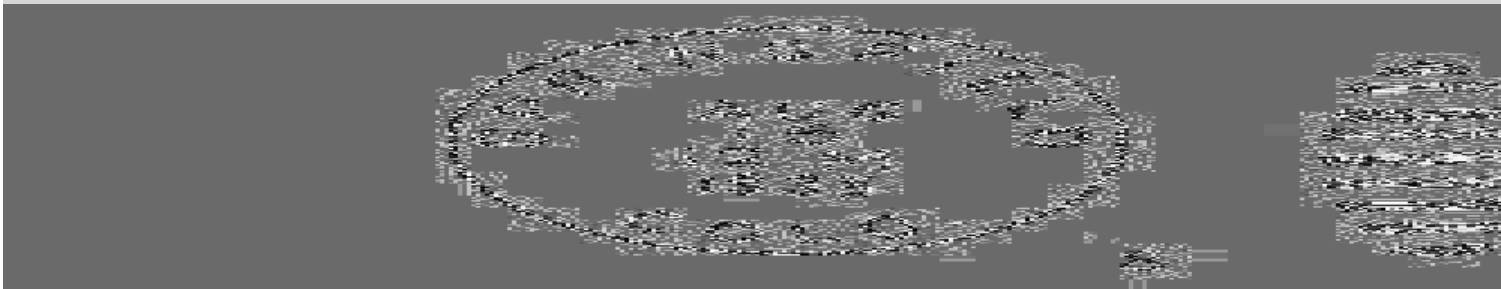
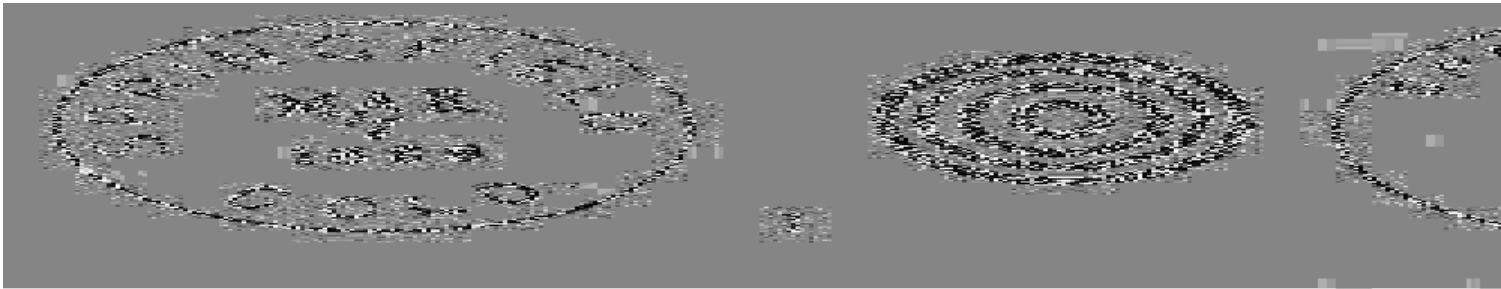

SPRINGFIELD – Continued



SPRINGFIELD STATIONS

SPRINGFIELD - CELEBRATE THE CENTURY STATION

Chronology of the Post Office

Jun 8 2000 Operated as a Special Commemorative Station

Confirmed types of postal markings

1 Springfield CO 80754 // Celebrate the Century Station Jun 8 2000
SL 00R 54.0x13.0 Pict Text only - CENTENARIAN / -- 100 -- /
The Life of a Century



SPRINGFIELD - CENTENNIAL STATION

Chronology of the Post Office

Aug 8 1987 Operated as a Special Commemorative Station

Confirmed types of postal markings

1 SPRINGFIELD, COLORADO / CENTENNIAL STA 81073 Aug 8 1987
RC 10P 75.0x46.0 Pict - Steer and scene in box; 1887 / 1987

SPRINGFIELD STATIONS – Continued

SPRINGFIELD EQUINOX FESTIVAL STATION – Continued

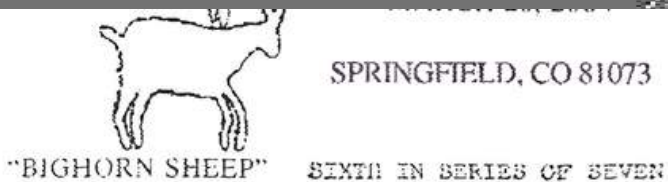
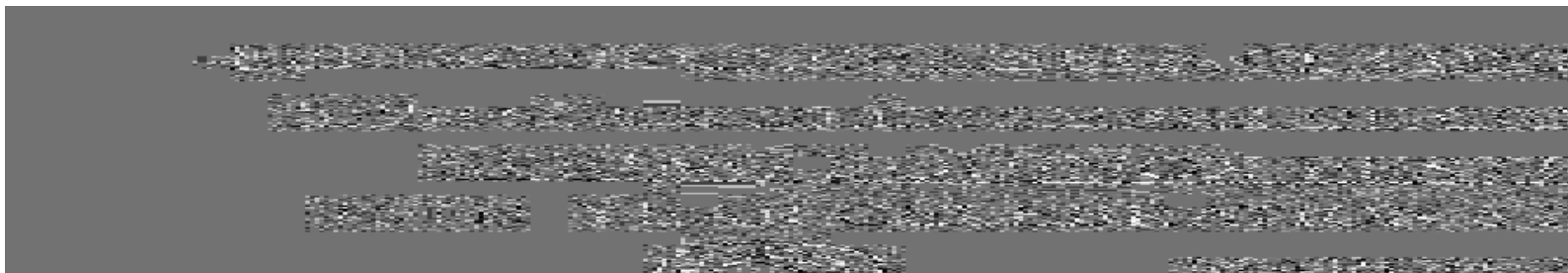

6

Springfield Fall Equinox
Festival Station 81073

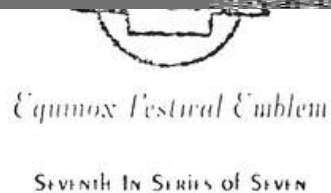

7

SPRINGFIELD STATION

Chronology of the Post Office

May 7 2009 Operated as a Special Commemorative Station

Confirmed types of postal markings

- 1 SPRINGFIELD, CO / 81703 :: SPRINGFIELD STATION May 7 2009
Pict Scene - Maggie Simpson, spilled bottle; Text –
The Simpsons [First Day of Issue for the Simpsons stamps]

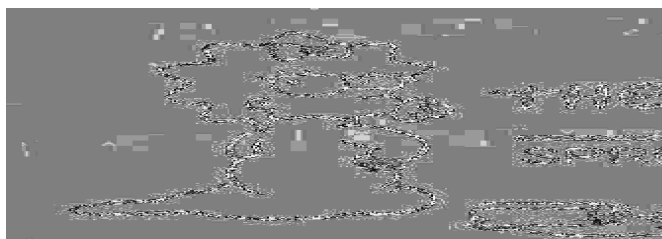

STEVENSON

[Ed. Note SRM: Bill Bauer discovered very little information on Stevenson. He wasn't sure whether it was in Las Animas or Baca County; he decided on Baca. Here's what he wrote:]

By error this post office was listed under Las Animas County in our 1970 book *Colorado Postal History - The Post Offices*. I believe the error occurred because the Stevenson Post Office was established and closed before Baca County was carved from eastern Las Animas County in 1889.

Without a Geographical Site Location Report to the contrary, the error was perpetuated in the 1990 book *Colorado Post Offices*.

STEVENSON – Continued

In addition I found something, lost somewhere in the dim recesses of my mind, that caused me to locate a Stevenson about a mile northwest of Boncarbo in Las Animas County.

It was not until I was preparing this chapter [Las Animas] that I realized that if the Stevenson Post Office was near Boncarbo, that when it was discontinued the mail would not have been sent to Stonington.

This note is by way of apology for the error and to avoid any further confusion.

Stevenson will be added to Baca County by way of an addendum.

Another post office named STEVENSON east of Springfield and almost on the Kansas line existed briefly in 1888, but the name can be found on later maps.

Chronology of the Post Office

	No entry present in Geographic Site Location Reports
Dec 10 1887 ---	NW/4 Sec 14 T31S R42W
	1-1/2 miles south of Sand Arroyo.
	Proposed postmaster - William Evans
Feb 15 1888	Established
Feb 15 1888	Evans, William
Oct 30 1888	Discontinued Papers to Stonington ????

Confirmed types of postal markings

NO POSTAL MARKINGS HAVE BEEN REPORTED FROM STEVENSON

STONINGTON

If the historical references are correct, Stonington began life as “Adams,” promoted by a group of men from Kansas who formed the Adams Town Company. The location of Adams was about three miles southwest of the present site of Stonington. The change in name to Stonington most likely occurred when application for a post office was made. The initial Geographic Site Location Report does not mention Adams. The early document in the Geographic Site Location Reports is for a location in section 15, Township 32 South, Range 43 West. This is five miles southwest of present day Stonington and I believe was the original “Adams” site.

This settlement suffered through the drought of the 1890’s. In the early 1900’s a new wave of migration began and a new community sprang up to the northwest. W. A. Thompson built a store at the new site and a sizeable community began to grow. The post office was moved from Old Stonington to New Stonington, however, the Geographic site Location Reports fail to provide an answer as to exactly when this took place. It was some time before 1920 and probably about 1909 when Thompson built his store.

Another question relative to Stonington is the source of the name. One version claims that the name was taken from a nearby stream that was full of rocks and stones. A second version attributes the name to the surname of a man who lived there and operated the post office. However, there is no similar name in the Post Office Records of Postmaster Appointments. The third version states that it was named for Stonington, Massachusetts, the hometown of many of the settlers in the area. However, there is no listing for a Stonington post office in Massachusetts. There is an Adams, Massachusetts so perhaps the Massachusetts legend applies to it.

From Walsh, drive 6 miles south on Road 44, then turn east on Road X, five miles to Stonington. This is still an active community with several residences and a church, however, the post office closed in 1990 and the residents must now rely on other larger towns for services and supplies.

STONINGTON – Continued



Abandoned church, Stonington, Colorado
 Photograph by William H. Bauer May 3, 1998

Latitude = 37:17:37-North Longitude = 102:11:13-West

Chronology of the Post Office

Jan 29 1888	---	Sec 16 T32S R43W 1 mile north of the North Fork. Proposed postmaster - Hobart P. Vermilye	
Jan 20 1888		Established	
Jan 20 1888		Brown, Samuel E.	
Aug 17 1891		Penney [Penny?], Mary	
Sep 7 1894		Konkel, Simeon J.	
Nov 23 1903		Walden [Waldren?], Maud E.	
Jan 28 1905 [1908?]		Walden [Waldren?], Christopher B.	
Jun 21 1907		Thompson, William A.	
Mar 4 1914	---	SE/4 Sec 31 T31S R42W	
May 20 1916		Campbell, Bessie H.	
Nov 14 1916		Powell, Robert B.	
Nov 26 1920	---	NE/4 Sec 6 T32S R42W 2-1/2 miles north of the North Fork. Site changed 150 yards north of a previous location.	
Oct 16 1920		Kerr, Robert B.	
Jul 1 1922			Office made Presidential
Aug 8 1922		Kerr, Robert B.	P&S
Nov 16 1926		Kerr, Ernest	Acting
Feb 2 1928		Bourquin, Alvin L.	
Jul 1 1928		Bourquin, Alvin L. [?]	Relegated
Aug 15 1928		Bourquin, Alvin L.	
Nov 1 1941	---	NE/4 Sec 6 T32s R42W	
Jul 1 1944		Tutt, Mrs. Dorothy J.	Assumed charge
Jul 8 1944		Tutt, Mrs. Dorothy J.	Acting

STONINGTON – Continued

Aug 22 1944	Whisenand, Kenneth D.	Assumed charge
Sep 25 1944	Whisenand, Kenneth D.	Acting
Mar 5 1945	Perras, Clyde A.	Assumed charge
Dec 7 1945	Perras, Clyde A.	Confirmed
Jan 22 1946	Perras, Clyde A.	Commissioned
May 20 1947	Crissman, Gipson O.	Assumed charge
Jul 21 1947	Crissman, Gipson O.	Confirmed
Aug 21 1947	Crissman, Gipson O.	Commissioned
Dec 8 1949	Davis, Vesper Dale	Assumed charge
Dec 30 1949	Davis, Vesper Dale	Confirmed
Feb 1 1950	Davis, Vesper Dale	Commissioned
Apr 30 1950	Burhenn, George H.	Assumed charge
Jun 5 1950	Burhenn, George H.	Confirmed
Jul 28 1950	Burhenn, George H.	Commissioned
Mar 31 1951	Day, Mrs. Alice	Assumed charge
Apr 10 1951	Day, Mrs. Alice	Acting
Jul 5 1951	Day, Mrs. Alice	Confirmed
Aug 7 1951	Day, Mrs. Alice	Commissioned
Dec 9 1955	Grimsley, Marie J.	Assumed charge
Dec 23 1955	Grimsley, Mrs. Marie J.	Acting
Feb 10 1956	Grimsley, Mrs. Marie J.	Confirmed
Feb 19 1956	Grimsley, Marie J.	Appointed
Mar 20 1956	Grimsley, Marie J.	Commissioned
Mar 31 1956	Grimsley, Marie J.	Possession
May 27 1960	Fowler, Mrs. Aleatha J.	Assumed charge
May 31 1960	Fowler, Mrs. Aleatha J.	Acting
Oct 12 1960	Fowler, Aleatha J.	Commissioned
Oct 14 1960	Fowler, Aleatha J.	Possession
Oct 17 1960	Fowler, Mrs. Aleatha J.	Confirmed
Dec 9 1960	Fowler, Aleatha J.	Acting
Jul 31 1971	Burhenn, Mrs. V. Armilda	Acting
Jul 31 1971	Burhenn, Mrs. V. Armilda	Commissioned
Jul 31 1971	Burhenn, Mrs. V. Armilda	Possession
Apr 21 1990	Service Suspended	
Dec 12 1992	Discontinued Mail to Walsh	

Confirmed types of postal markings

1	Stonington Colo MS	Mscp Pen cancel	Feb 27 1888	Mar 24 1888
2	STONINGTON / COLO. CI 10P 27.0	Hstp Target, 4 ring 16mm	Jun 13 1888	Jan 2 1905
3	STONINGTON, / COLO. CI 10P 31.0	4bars S-24x20mm	Jul 5 1909	May 28 1919
4	STONINGTON / COLO. CI 10P 29.0	4bars S-??x??mm	Oct 19 1908	Jun 24 1912
5	STONINGTON / COLO. CI 10P 29.5	Dplx Grid, 9-bar oval	Jan 15 1940	Jun 7 1943
6	STONINGTON / COLO. CI 10P 33.0	4bars S-24x20mm	Oct 7 1946	Feb 15 1962
7	STONINGTON, CO / 81075 CI 10P 32.0	4bars S-25x20mm	Aug 30 1969	Sep 17 1975
8	STONINGTON, CO / 81075 CI 10P 34.0	4bars S-26x21mm	Jan 20 1988	Apr 14 1988

STONINGTON – Continued

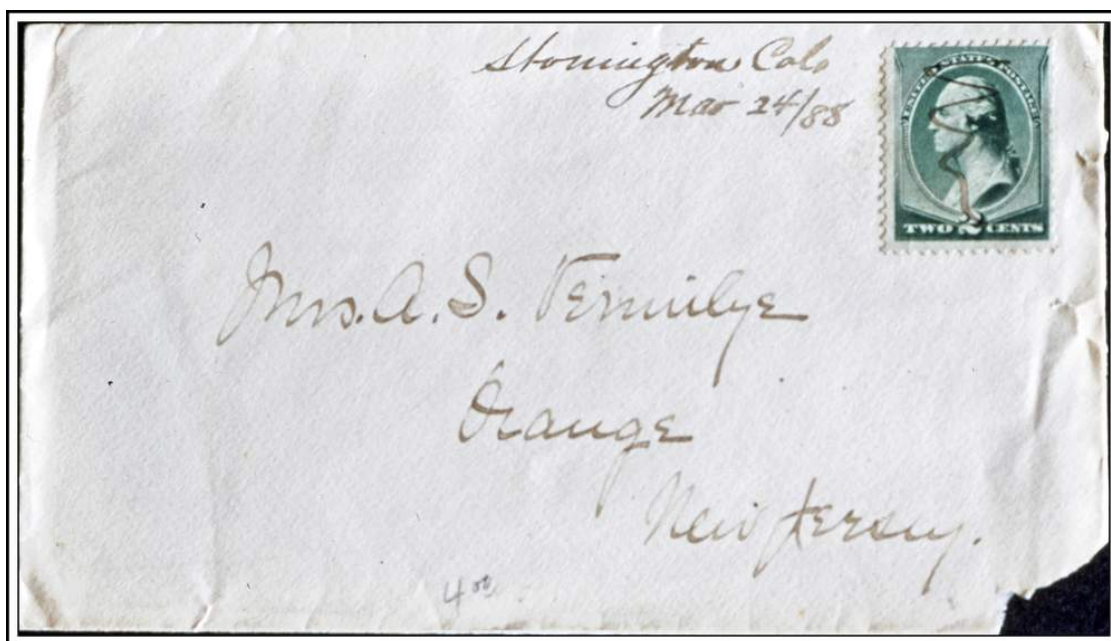
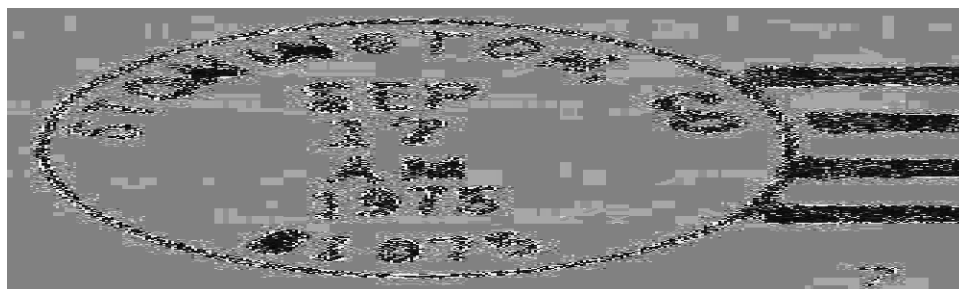
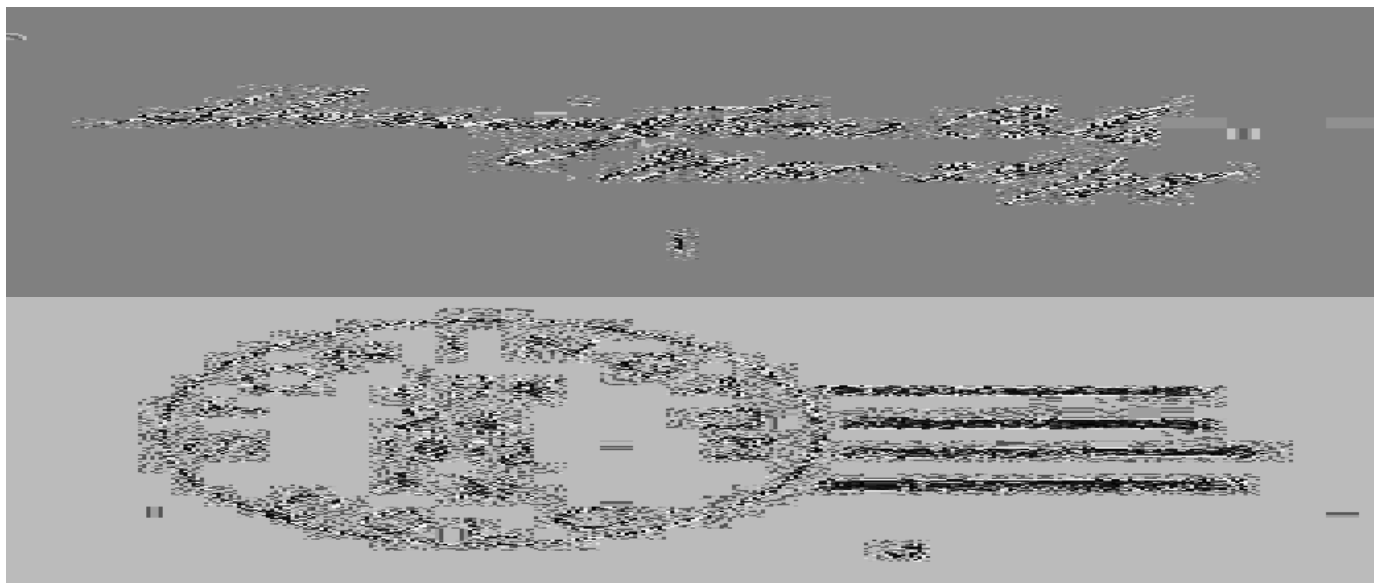

Stonington Colo

March 24, 1888

TOWNSITE

Townsite was a small settlement that was associated with the development and mining activity at Corrizo. It is not mentioned in the historical literature. The name is unusual and may indicate that no permanent name was chosen for the place. The application for a post office suggested "Copper" but that was rejected.

For directions to this post office, see CARRISO.

To reach the Townsite: From the junction of County Roads 3.5 and J, drive south on Road 3.5 about two and one-half miles to the Dunlap Ranch. This is the location for Townsite as plotted from the Geographic Site Location Reports. There is an old stone ranch house, some stone out-buildings, a wooden windmill and a cistern. A half-mile north are some newer ranch buildings.

Chronology of the Post Office

Feb 12 1900	---	SE/4 Sec 21 T34S R50W	The suggested name "Copper" was rejected. 1/2 mile west of Carrizo Creek.
Mar 18 1900		Established	
Mar 19 1900		Darling, Jonathan	
Nov 28 1902		Ordered closed	
Dec 31 1902		Discontinued	Papers to Carrizo

Confirmed types of postal markings

NO POSTAL MARKINGS HAVE BEEN REPORTED FROM TOWNSITE

TUCK

I have found no reference to this settlement in the historical literature. Tuck had a post office for a little less than two years before it was moved some five miles west and south to become Utleyville.

For directions to this post office, see CARRISO.

There were some scatted bricks and other rubble at this location.

Chronology of the Post Office

Nov 2 1915	---	SW/4 Sec 1 T32S R50W	There may have been a request to name the place "Butte." Applicant for postmaster - Mrs. Belle Wilkinson
Feb 16 1916		Established	
Feb 16 1916		Wilkinson, Belle	
Jun 9 1917		Moved to Utleyville / Name changed to Utleyville.	NOTE: This entry appears in Postmaster records, but with no explanation. Perhaps it was a failed attempt to re-establish a Post Office at Tuck.
Sep 7 1917		Ward, Belle	

Confirmed types of postal markings

NO POSTAL MARKINGS HAVE BEEN REPORTED FROM TUCK

TWO BUTTES

Lamar banker A. N. Parrish representing the Two Buttes Land Company filed a town plat for Two Buttes on October 20, 1909. Parrish was attempting to capitalize on a nearby dam and recreation area. The town was incorporated October 19, 1911. The name was taken from two isolated, prominent buttes near the Baca-Prowers County line, about thirteen miles north of the town.

Two Buttes is still an active agricultural community offering some commercial services to the northern portion of Baca County. However, like so many of the towns of the eastern Colorado plains it is gradually shrinking.

Two Buttes is on Colorado Highway 116, twelve miles east of US 287/385.

Latitude = 37:33:40-North Longitude = 102:23:50-West

**TWO BUTTES – Continued
Chronology of the Post Office**

Oct 11 1909	---	SW/4 Sec 32 T28S R44W Proposed postmaster - Jay V. Saylor	
Mar 1 1910		Established	
Mar 1 1910		Saylor [Saylor?], Jay V.	
May 19 1913		Jones, Lea D.	
Apr 10 1914	---	SW/4 Sec 32 T28S R44W	
Apr 7 1915		Allen, Alfred B.	
Mar 18 1920		Fuller, Mary J.	
Jul 1 1921		Fuller, Mary J.	Presidential
Dec 16 1921		Fuller, Mary J.	P&S
Jul 1 1922		Fuller, Mary J.	Relegated
Jan 4 1923		Fuller, Mary J.	
Oct 1 1923		Fuller, Mary J.	Presidential
Dec 18 1923		Fuller, Mary J.	
Aug 15 1925		Backus, Leona E.	Acting
Dec 14 1925		Backus, Leona E.	Appointed
Jul 1 1926		Backus, Leona E.	Relegated
Jul 20 1926		Backus, Leona E.	
Jul 1 1927		Backus, Leona E.	Presidential
Dec 15 1927		Backus, Leona E.	Confirmed
Feb 15 1932		Backus, Leona E.	Nominated
Feb 26 1932		Backus, Leona E.	Confirmed
Apr 4 1932		Backus, Leona E.	Commissioned
Aug 13 1934		Backus, Leona E.	Confirmed
Sep 13 1934		Backus, Leona E.	Commissioned
Jun 15 1935		Backus, Leona E.	Nominated
Jul 2 1935		Backus, Leona E.	Confirmed
Jul 9 1935		Backus, Leona E.	Appointed Presidential
Aug 16 1935		Backus, Leona E.	Commissioned
Jul 30 1936		Backus, Leona E.	Confirmed
Oct 20 1936		Backus, Leona E.	Commissioned
Oct 3 1941	---	SW/4 Sec 32 T28S R44W	
Jul 31 1956		Stolebarger, Joe E.	Assumed charge
Aug 13 1956		Stolebarger, Joe E.	Acting
Apr 5 1957		Stolebarger, Joe E.	Possession
Apr 9 1957		Stolebarger, Joe E.	Appointed
Jul 1 1971			Office advanced to 3rd class

Confirmed types of postal markings

1	TWO BUTTES, / COLO. CI 10P 31.0	4bars S-??x14mm	May 28 1910	Apr 28 1917
2	TWO BUTTES / COLO. CI 10P 29.0	Dplx Grid, 9-bar oval	Jul 14 1925	
3	TWO BUTTES / COLO. CI 10P 33.0	4bars S-24x18mm	Feb 22 1933	Mar 7 1936
4	TWO BUTTES / COLO. CI 10P 33.0	4bars S-25x18mm	Apr 27 1937	Dec 26 1957
5	TWO BUTTES / COLO CI 10P 33.0	4bars S-22x20mm	Jul 20 1957	Nov 21 1962
6	TWO BUTTES, CO / 81084 CI 10P 33.0	4bars S-23x19mm	Jun 8 1965	Nov 17 1977
7	TWO BUTTES, CO / 81084 CI 10P 33.0	4bars S-25x19mm	May 30 1991	Jun 1 1993

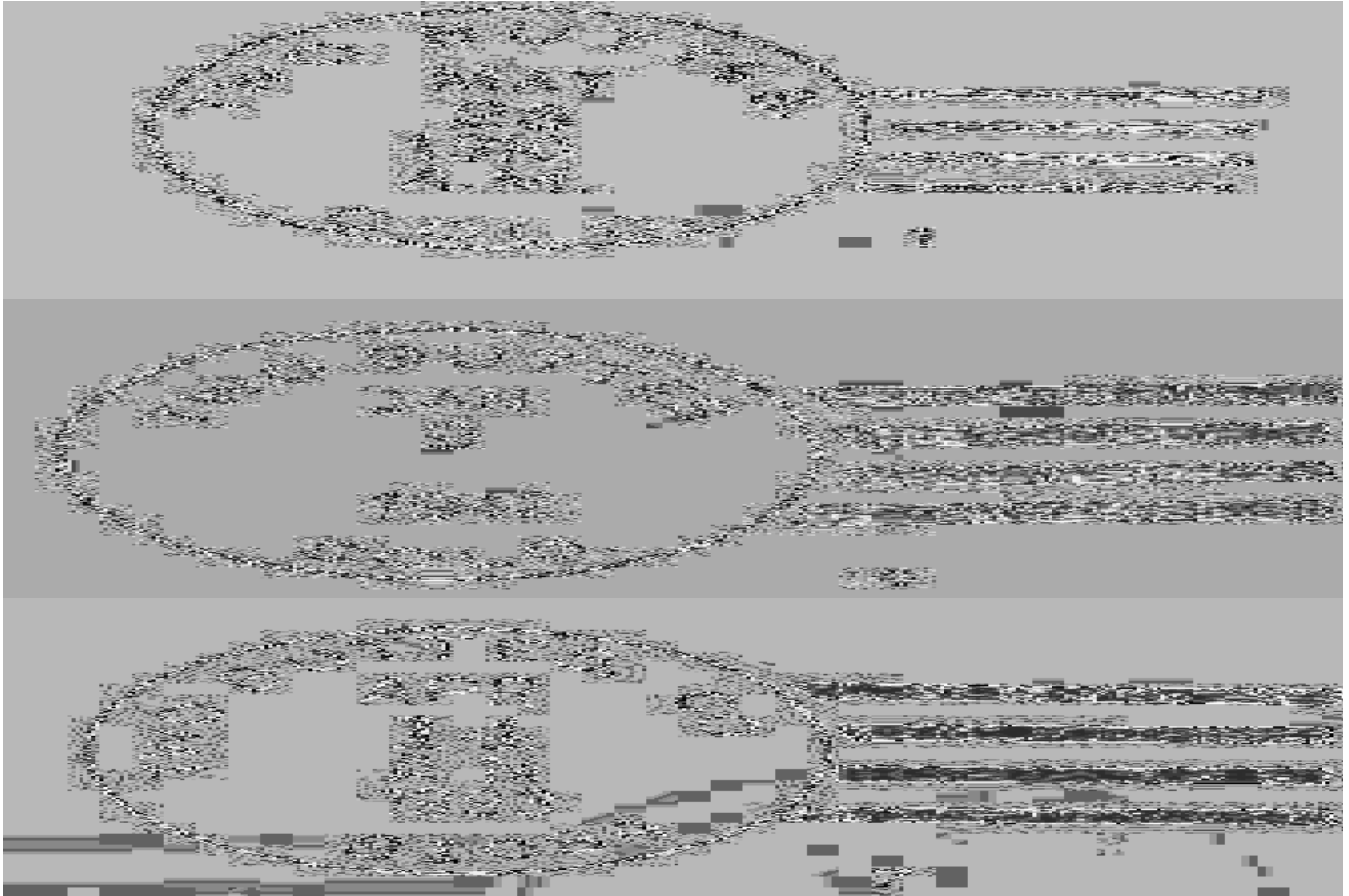
TWO BUTTES – Continued**UTLEYVILLE**

Azel H. Utley was appointed as a postmaster in 1917. He moved the post office at Tuck west to his ranch and renamed it Utleyville. Utleyville was a small farming village. In 1943 the post office was moved again, to the home of a new postmaster. The post office continued operation until 1973.

For detailed directions to this post office, see CARRISO.

The original location of Utleyville is at the junction of County Road 2 and US 160, south of US 160 and east of Road 2. Nothing is visible except a couple of trees about a quarter-mile to the south. The later site is one mile east on US 160 and one mile south on Road 3. In 1997 there was a stone building present at this site.

Latitude = 37:16:16-North Longitude = 103:01:51-West

Chronology of the Post Office

Jul 6 1917	---	NE/4 Sec 8 T32S R50W	
Jun 9 1917		Moved from Tuck	
Jun 9 1917		Utley, Azel H.	
Jun 1 1920		Deeds, Cyrus J.	
Apr 13 1921		Bryan, Harvey T.	
Aug 11 1921		Beasley, Joe	
Mar 18 1926		DeLong, Isaac N.	Confirmed
Mar 30 1926		DeLong, Isaac N.	Commissioned
Apr 5 1926		DeLong, Isaac N.	Assumed charge

UTLEYVILLE – Continued

Aug 4 1936	Hummer, Lois	Possession
Aug 5 1936	Hummer, Lois	Assumed charge
Aug 12 1936	Hummer, Lois	Acting
Oct 27 1936	Hummer, Lois	Confirmed
Dec 9 1936	Hummer, Lois	Commissioned
Dec 31 1936	Hummer, Lois	
Jan 26 1938	Dowell, Lois	Name changed by marriage
Oct 17 1941 ---	NE/4 Sec 8 T32S R50W	
Apr 5 1943 ---	SW/4 Sec 10 T32S R50W	A move 1 mile east of a previous location.
	NOTE: "To save gas and tires driving to and from work and because we own the new site and rent the present location."	
Jun 27 1972	Dowell, Grover M. Jr.	Officer in charge
Jan 5 1973	Ordered closed	
Jan 18 1973	Discontinued Mail to Pritchett	

Confirmed types of postal markings

1	UTLEYVILLE, / COLO. CI 10P 33.0	4bars S-??x19mm	Jun 17 1935 Sep 15 1936
2	UTLEYVILLE / COLO. CI 10P 33.0	4bars S-25x19mm	Apr 24 1939 Jun 9 1943
3	UTLEYVILLE / COLO. CI 10P 33.0	4bars S-23x19mm	Jan 12 1943 Dec 14 1953
4	UTLEYVILLE / COLO. CI 10P 33.0	4bars S-22x19mm	Sep 9 1957 Jan 5 1962
5	UTLEYVILLE / COLO. CI 10P 33.0	4bars S-23x20mm	Jun 18 1963
6	UTLEYVILLE / CO. CI 10P 33.0	4bars S-??x20mm	May 15 1968 Oct 20 1970



VILAS

A group of investors from Comanche County Kansas organized the Southern Colorado Town Company in January 15, 1887. Incorporated under Colorado law they established company headquarters at Vilas and a town plat was filed July 18, 1887.

Vilas was an agricultural supply center and continues as such today, but is more of a residential center than the commercial center it once was.

VILAS – Continued

The name honors William F. Vilas, who was the Secretary of the Interior in Grover Cleveland's Cabinet (1888-1889), had been Postmaster General and later (1891-1897) was U.S. Senator from Wisconsin.

The community of Vilas is located one mile south of US 160 and nine miles east of Springfield.

Latitude = 37:22:25-North Longitude = 102:26:45-West

Chronology of the Post Office

Mar 5 1887	---	SW/4 Sec 1 T31S R45W Bear Creek 1-1/2 miles north of post office. Proposed postmaster - Robert A. Crossman	
Jun 20 1887		Established	
Jun 20 1887		Crossman, Robert A.	
May 4 1888		Carlton, Sarah L.	
Dec 28 1889		Kirkman, Alza	
Jun 10 1894		Thompson, Alice	
Sep 23 1902		Yokum, Lillie M.	
Mar 15 1914	---	SW/4 Sec 1 T31S R45W 2-1/2 miles south of Bear Creek.	
Aug 17 1920		Hagerman, Luella C.	
May 1 1928		Thompson, Sarah	Possession
May 15 1928		Thompson, Sarah	Acting
Oct 22 1928		Thompson, Sarah	Appointed
Apr 26 1929		Amrine, Alva	Confirmed
May 9 1929		Amrine, Alva	Commissioned
May 14 1929		Amrine, Alva	Assumed charge
Dec 12 1931		Porter, Miss Joy G.	Assumed charge
Jan 7 1932		Porter, Miss Joy G.	Acting
May 7 1932		Baldwin, John A.	Confirmed
May 19 1932		Baldwin, John A.	Commissioned
May 24 1932		Baldwin, John A.	Assumed charge
Jan 22 1934		Butler, L. Belle	Assumed charge
Feb 7 1934		Butler, L. Belle	Acting
Apr 25 1935		Hutson, James H.	Confirmed
May 16 1935		Hutson, James H.	Commissioned
May 21 1935		Hutson, James H.	Assumed charge
Sep 1 1936		Jackson, Owen Lewis	Acting
Sep 1 1936		Jackson, Owen Lewis	Assumed charge
May 27 1937		Jackson, Owen Lewis	Confirmed
Jun 10 1937		Jackson, Owen Lewis	Commissioned
Oct 22 1941	---	Sec 1 T31S R44W (R44W or R45W? Did these people know where they were?) Bear Creek 3 miles north of Post Office.	
Jun 26 1943		Jackson, Mrs. Minnie A.	Assumed charge
Jul 9 1943		Jackson, Mrs. Minnie A.	Acting
May 1 1944		Jackson, Mrs. Minnie A.	Confirmed
May 31 1944		Jackson, Mrs. Minnie A.	Commissioned
Oct 25 1947	---	NW/4 Sec 1 T31N R44W Bear Creek is 1-1/2 mile north of post office. A move 300 feet east of a previous location	
Mar 23 1948		Konkel, Mrs. Joyce M.	Assumed charge
Jun 8 1948		Stubblefield, Mrs. Pearl E.	Acting
Jun 18 1948		Stubblefield, Mrs. Pearl E.	Assumed charge
Mar 17 1949		Stubblefield, Mrs. Pearl E.	Confirmed
Apr 6 1949		Stubblefield, Mrs. Pearl E.	Commissioned
Jun 17 1948		Rose, Pearl E.	Possession
Aug 6 1948		Rose, Pearl E.	Acting
Mar 17 1949		Rose, Pearl E.	Appointed
Apr 6 1949		Rose, Pearl E.	Commissioned
Jun 30 1949		Rose, Pearl E.	Possession

VILAS – Continued

Sep 23 1960	Rose, Mrs. Pearl E.	Name changed by marriage
Dec 9 1966	Greenlee, Olive	Acting
Dec 19 1968	Doyle, Clarence J.	Appointed, Declined appointment
Jul 1 1971		Office advanced to 3rd class
Nov 31 1971	Greenlee, Olive	Appointed & Commissioned

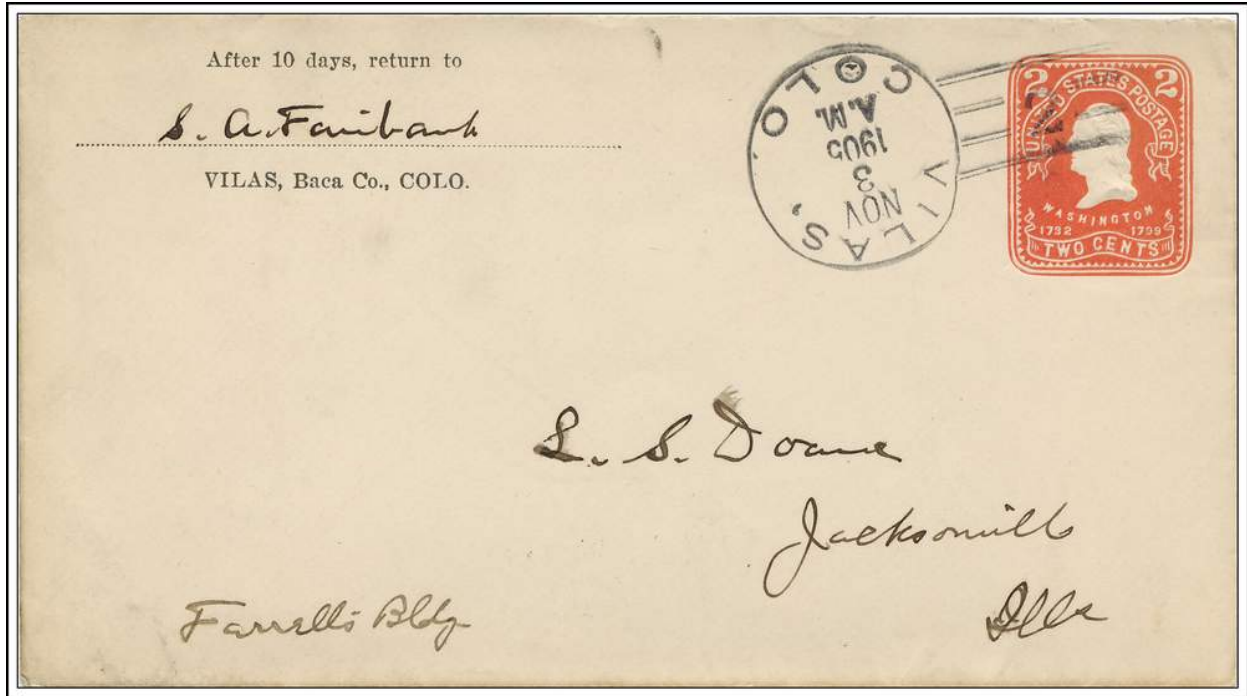

VILAS, / COLO. Doane Type 2 with 2; Bars at left of cds November 3, 1905

Confirmed types of postal markings

1	VILAS / COLO. CI 10P 28.5	Hstp Target, 4 ring 17mm	Sep 13 1887 Dec 5 1888
2	VILAS / COLO. CI 10P 27.0	Hstp Target, 4 ring 17mm	Aug 3 1891 Aug 2 1901
3a	VILAS, / COLO. CI 10P 28.0	Doane Type 2 with 2; S-24x13mm	Mar 13 1905 Mar 24 1905
3b	VILAS, / COLO. CI 10P 28.0	Doane Type 2 with 2; S-24x13mm; line bars at left of cds	Jul 31 1905 Jan 24 1906
4	VILAS / COLO. CI 10P 31.0	4bars S-??x13mm	Mar 16 1910 Aug 15 1916
5	VILAS. / COLO. CI 10P 32.0	4bars S-24x20mm	Jun 27 1914
6	VILAS / COLO. CI 10P 33.0	4bars S-??x19mm	Nov 7 1929
7	VILAS, COLO. CI 10P 31.0	4bars P-26x20mm	Feb 16 1933 Jan 12 1942
8	VILAS / COLO. CI 10P 32.0	4bars S-24x19mm	Feb 18 1943 Nov 1 1946
9	VILAS, COLO. / REGISTERED CI 11P 29.0/20.0	Hstp No killer	Jul 14 1944
10	VILAS / COLO. CI 10P 32.0	4bars S-??x18mm	Apr 26 1954 Dec 1 1958
11	VILAS / COLO. CI 10P 33.0	4bars S-24x19mm	Feb 19 1962 Nov 21 1962

VILAS – Continued

- | | | | |
|----|----------------------------------|-----------------|-------------------------|
| 12 | VILAS, CO / 81087
CI 10P 33.0 | 4bars S-24x19mm | Jun 29 1966 Apr 8 1987 |
| 13 | VILAS, CO / 81087
CI 10P 32.0 | 4bars S-23x19mm | May 21 1991 Mar 25 1993 |

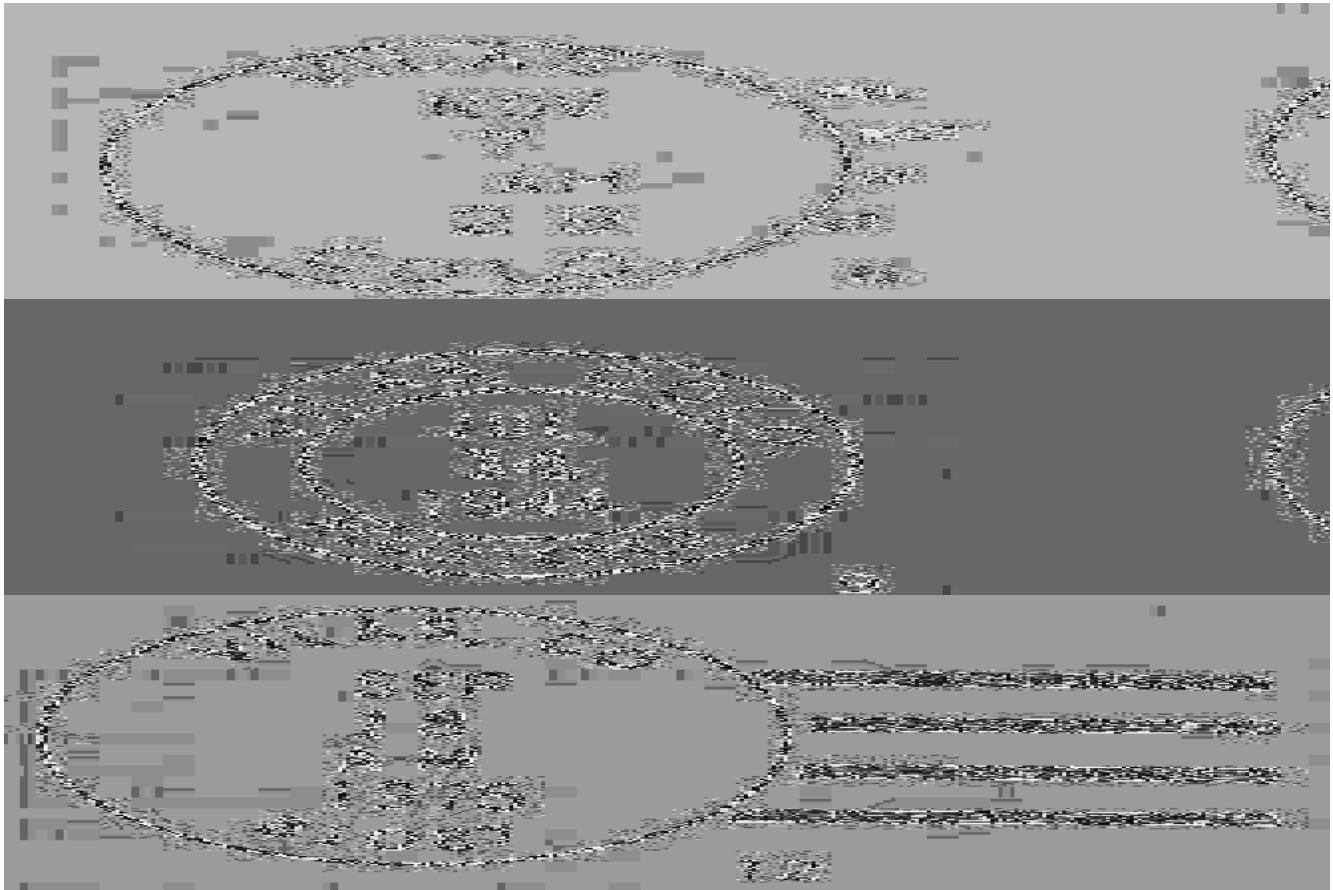
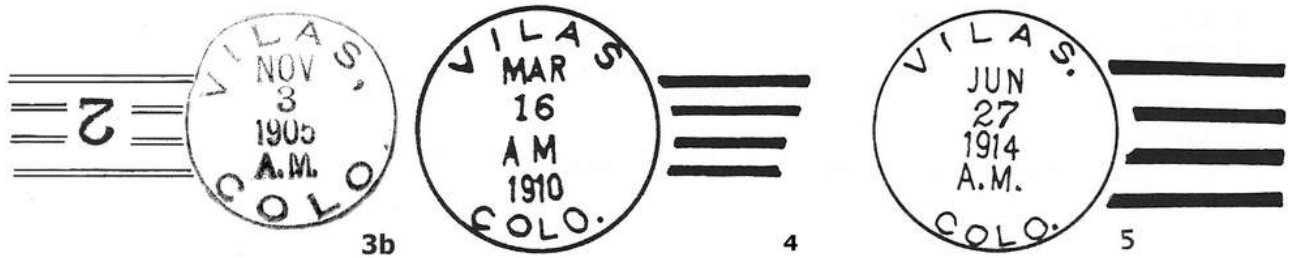
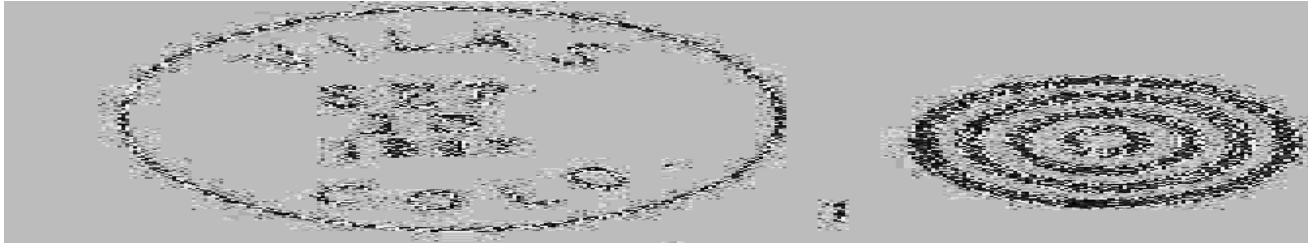

VILAS – Continued

VILAS CENTENNIAL STATION

Chronology of the Post Office

Jun 20 1987 Operated as a Special Commemorative Station

Confirmed types of postal markings

- 1 VILAS, COLORADO / U.S.P.S. CENTENNIAL STATION / 81087 Jun 20 1987
RC 20P 69x44/66x41 Pict - Street Scene; 1887 - 1987, with cachet

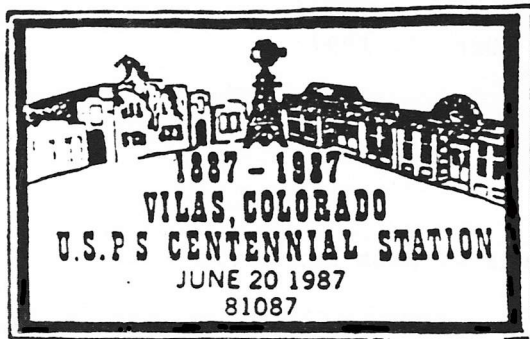

1

WALSH

The Dodge City and Cimarron Valley Railway, a subsidiary of the Atchison, Topeka and Santa Fe Railway, built into the area in 1926 and a town plat for Walsh was filed on September 23, 1926. Much of the growth came from former residents of Stonington who moved to the new town on the railroad. Walsh was and still is a shipping and supply point for much of Eastern Baca County. Walsh was incorporated in 1928.

Reportedly the town was named for the first general baggage agent of the railway. Walsh is located on US 160, nineteen miles east of Springfield and nine miles east of Vilas.

Latitude = 37:23:10-North Longitude = 102:16:40-West

Chronology of the Post Office

- | | | | |
|-------------|-----|---|--------------------------|
| Oct 29 1926 | --- | SE/4 Sec 32 T30S R43W Bear Creek 1-1/2 miles north of Post Office site.
Applicant for postmaster - Robert B. Kerr | |
| Dec 23 1926 | | Established | |
| Dec 23 1926 | | Kerr, Robert B. | |
| Jul 1 1929 | | | Office made Presidential |
| Sep 18 1929 | | Kerr, Robert B. | |
| Apr 16 1934 | | Raney, Carl E. | Acting |
| Apr 23 1934 | | Raney, Carl E. | Assumed charge |
| Jan 10 1935 | | Raney, Carl E. | Nominated |
| Jan 21 1935 | | Raney, Carl E. | Confirmed |
| Feb 19 1935 | | Raney, Carl E. | Commissioned |
| Mar 31 1935 | | Raney, Carl E. | Assumed charge |
| Jun 5 1939 | | Raney, Carl E. | Nominated |
| Jun 12 1939 | | Raney, Carl E. | Confirmed |
| Jun 15 1939 | | Raney, Carl E. | Appointed Presidential |
| Jun 30 1939 | | Raney, Carl E. | Commissioned |
| Oct 22 1941 | --- | E/4 Sec 32 T30S R43W Main Street, State Highway 100 (east-west)
about 150 feet from Post Office. | |
| Jan 7 1957 | | Smith, Mary L. | Assumed charge |

WALSH – Continued

Jan 17 1957	Smith, Mary L.	Acting
Feb 13 1958	Godfrey, Clarence M.	Nominated
May 22 1958	Godfrey, Clarence M.	Confirmed, Apptd Presidential & Commissioned
Jun 19 1958	Godfrey, Clarence M.	Assumed charge



Post Office, Walsh, Colorado

Photograph by William H. Bauer

October 4, 1997

Confirmed types of postal markings

0.1	WALSH, / COLO. CI 10H 32.0	4bars S-24x19mm	Feb 13 1928
1	WALSH / COLO. CI 10P 29.0	Dplx Grid, 9-bar oval	Feb 16 1933 Aug 31 1939
2	WALSH, COLO. CI 10H 32.0	4bars P-25x19mm	Jul 3 1935 Dec 31 1941
3	WALSH / COLO. CI 10P 30.0	Dplx Grid, diamond with 1	Aug 5 1940 Apr 18 1960
3.1	WALSH / COLO. RC 10P 36.0x16.5	No killer, Parcel Post Box style	1950s [NOT AVAILABLE FOR ILLUSTRATION]
4	WALSH, / COLO. CI 10P 22.5	Mach 7 wavy lines	Aug 17 1964
5	WALSH, CO / 81090 CI 10P 34.0	4bars S-24x19mm	Oct 2 1972 Sep 21 1976
6	WALSH, CO / 81090 CI 10P 23.0	Mach 7 wavy lines	May 28 1966 Oct 4 1997
7	WALSH, CO / 81090 CI 10P ???	4bars S-25x20mm	Apr 10 1986
8	WALSH, CO / USPS CI 11P 29.0/19.0	Hstp No killer	Oct 4 1997

WALSH – Continued

9 WALSH / CO 81090
RC 10P 38.0x18.0

Jul - - 2000
Hstp No killer, Parcel Post Box style

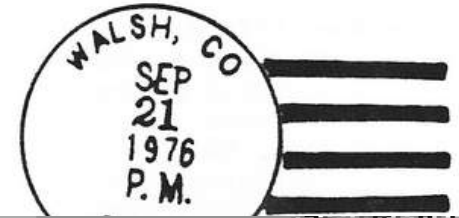
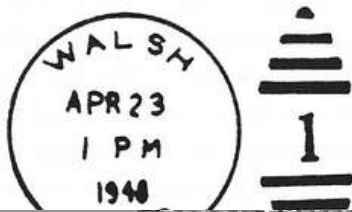
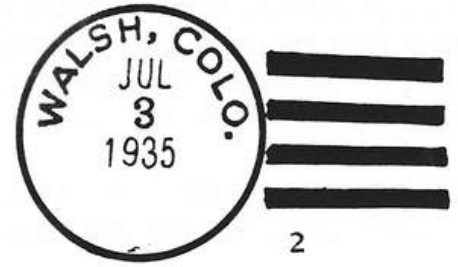
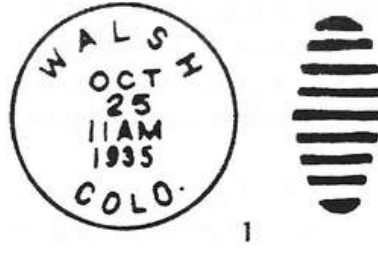
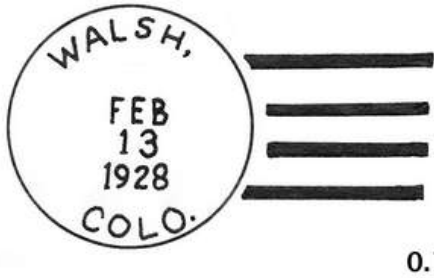

WALSH - CELEBRATE THE CENTURY STATION

Chronology of the Post Office

Jun 15 2000 Operated as a Special Commemorative Station

Confirmed types of postal markings

1 Walsh, CO 81090 // Celebrate the Century Station Jun 15 2000
SL 00R 94.0x3.0 Pict Text only - CENTENARIAN / -- 100 -- /
The Life of a Century



WENTWORTH

Wentworth was another of the rural post offices in the southeastern corner of Baca County. I have found no information about the settlement other than a general statement of its location. The Geographic Site Location Reports do provide a source for the name. The application for a post office was signed by Frank Wentworth, however, he did not become postmaster until two years after the office was established; the third postmaster of Wentworth.

From Stonington, drive south 5 miles on County Road 49 to County Road S. Turn east two miles to the location of Wentworth. This is another post office site that vanished from the landscape and any remaining traces have been plowed under.

Chronology of the Post Office

Oct 25 1909	---	NW/4 Sec 34 T32S R42W	
		Proposed postmaster - Frank Wentworth	
Jun 15 1911		Established	
Jun 15 1911		Sims, Paschal	Second name listed
Sep 9 1911		Stafford, Kate	First name listed
Oct 25 1913		Wentworth, Frank	
May 29 1916		Ray, John W.	
Apr 12 1921		Bourquin, Alvin L.	
Jun 6 1921		Ordered closed	
Jun 30 1921		Discontinued Mail to Stonington	

Confirmed types of postal markings

1 WENTWORTH, / COLO. Apr 7 1913 Aug 14 1914
CI 10P 32.0 4bars S-24x19mm

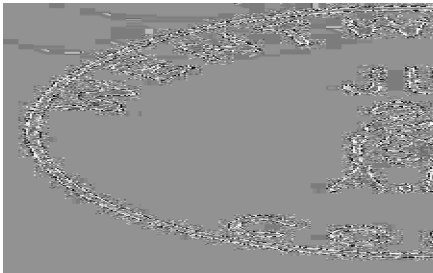
**WESTOLA**

The early history of Westola leaves some unanswered questions. It was first established on August 9, 1887 and discontinued April 15, 1903. It reopened May 25 1912 and was moved to a location in Colorado on August 20, 1914. The Geographic Site Location Reports, as do other documents, make it clear that these early locations were in Morton County Kansas and not far east of the Colorado border. However, in both instances the locations are clearly specified as being in "Range 43 West." That range is nine miles inside Colorado. I have never seen any indication that there was a renumbering of the Ranges, so how could two postmasters make the same error twenty-five years apart?

When it was re-established in 1912, Deans Ranch was the name suggested for the new location in Kansas, but that was rejected and I have no information as to the origin of the name Westola. It appears to be a contrived name. The move from Morton County Kansas brought the office into Colorado within a few hundred yards of the state line.

After the move to Colorado, only one postmaster served at Westola: Sam M. Dean. He knew where he was. In reply to an inquiry from Washington Mr. Dean wrote "This office is what might be called EXACTLY on the Colorado-Kansas state line..." And, he thought it should still be called "Westola, Kansas," but the Post Office department disagreed.

WESTOLA – Continued

Westola was yet another rural or ranch post office and not an organized community.

From Walsh, drive eleven and one half miles east to Road 55.5 (Konantz), then south four miles to Road Z and two miles east on Road Z to the site of Westola at the Kansas border. At the site there is an active ranch with some newer buildings, but it is the location as plotted from the Geographic Site Location Reports.

Chronology of the Post Office

- Jun 21 1887 --- Sec 16 T32S R43W (In Kansas) The suggested name "Deans Ranch" was rejected.
1 mile north of the north fork of the Cimarron River.
Proposed postmaster - James K. Estes**
- Apr 12 1912 --- NE/4 Sec 31 T31S R43W (In Kansas)
Proposed postmaster - George W. Dean
From the sketch map, this site was a little more than a half mile east
of the Kansas-Colorado state line (SW/4 OF NE/4).**
- Aug 20 1914 Established Apparently moved from Morton Co. Kansas
Aug 20 1914 Dean, Sam M.**
- Jan 21 1915 --- SE/4 Sec 21 T31S R41W (In Colorado)
"Just a claim house." "About 10 steps west of the Kansas
Colorado state line." (Note - there was a resurvey of this area.)**
- May 31 1917 Ordered closed Mail to Konantz
Feb 28 1918 Ordered closed Mail to Konantz
No indication of reason for two closing dates**

Confirmed types of postal markings

NO POSTAL MARKINGS HAVE BEEN REPORTED FROM WESTOLA

BIBLIOGRAPHY - BACA COUNTY

REFERENCES - BOOKS

- BENSON, Maxine *1001 Colorado Place Names*; 1994; University Press of Kansas; Lawrence, Kansas; 237pp; sketches
- BRIGHT, William *Colorado Place Names*; 1993; Johnson Books; Boulder, Colorado; 162pp
- EBERHART, Perry *Ghosts of the Colorado Plains*; 1986; Swallow Press; Athens, Ohio; 253pp; illus.; maps
- OSTEEN, Ike *A Place Called Baca*, 1979; Adams Press; Chicago, Illinois; 202pp; illus.; map
- TAYLOR, Ralph C. *Colorado South of the Border*; 1963; Sage Books; Denver, Colorado; 561pp; illus.; maps

REFERENCES - COLORADO MAGAZINE

- HUDNALL, Mary Prowers *Early History of Bent County*; November 1945, Vol. 22 No. 6; pp233-247
- TAYLOR, Morris F. *The Town Boom in Las Animas and Baca Counties*; Spring-Summer 1978, Vol. 55 No. 2-3, pp111-132; illus.; map
- Place Names in Colorado* [Alternate Title: *The Names of Colorado Towns*]
Prepared by the Colorado Writers Project; *Colorado Magazine*; Serialized in Volumes 17-20

GEOGRAPHIC SITE LOCATION REPORTS OF THE POST OFFICE DEPARTMENT

These are documents filed with applications for the approval of a new post office, at the time of a move of a post office and upon periodic requests of the Post Office Department. The documents may include a detailed location using the Federal Land Survey System, reference of distance to local streams and rivers, to railroads and to nearby existing post offices.

A COVER GALLERY OF BACA COUNTY

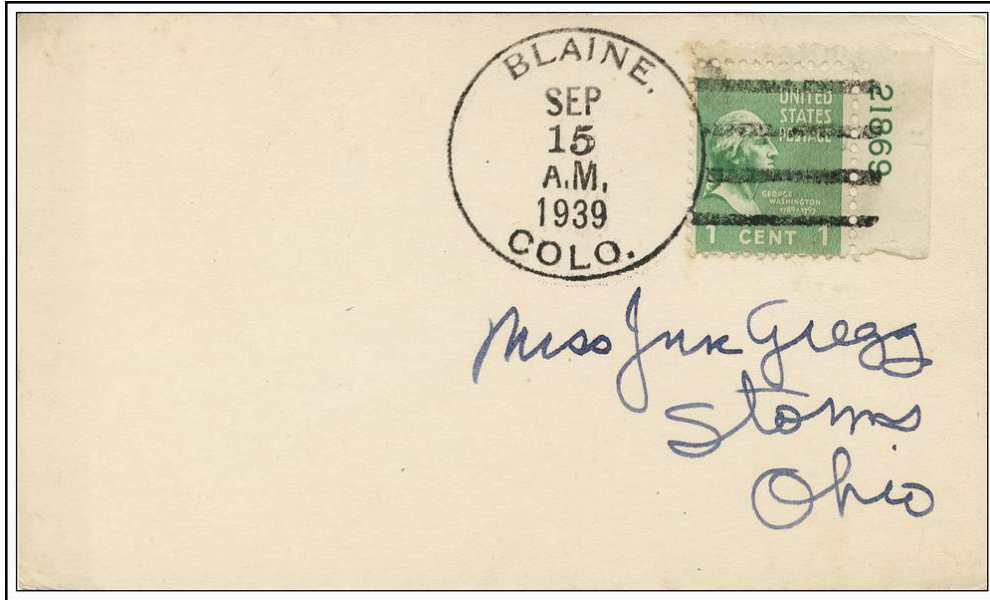

BLAINE, / COLO. September 15, 1939

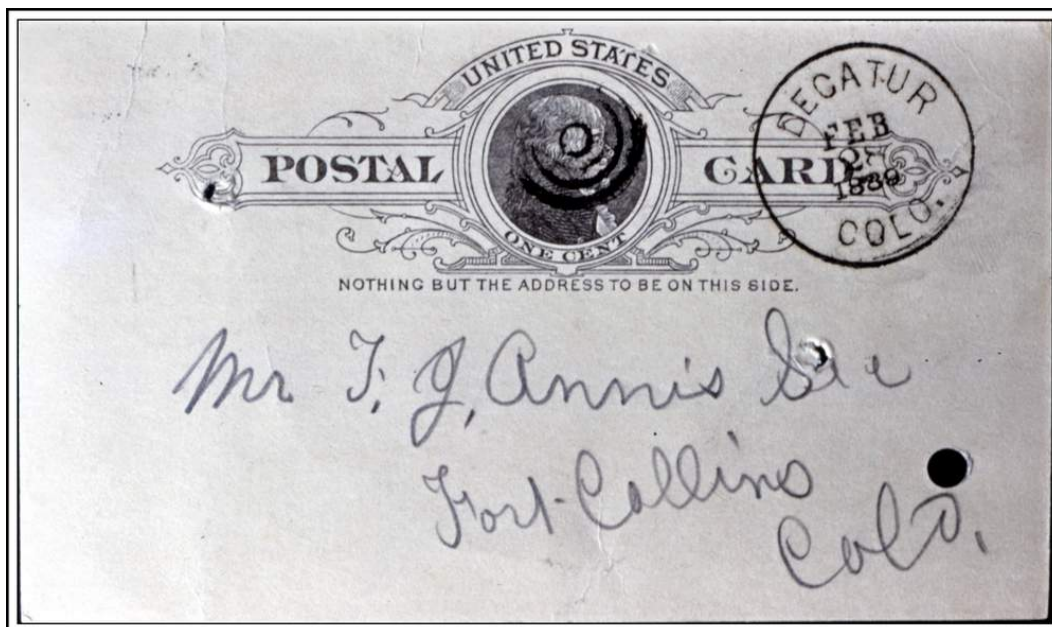

DECATUR / COLO. February 28, 1889

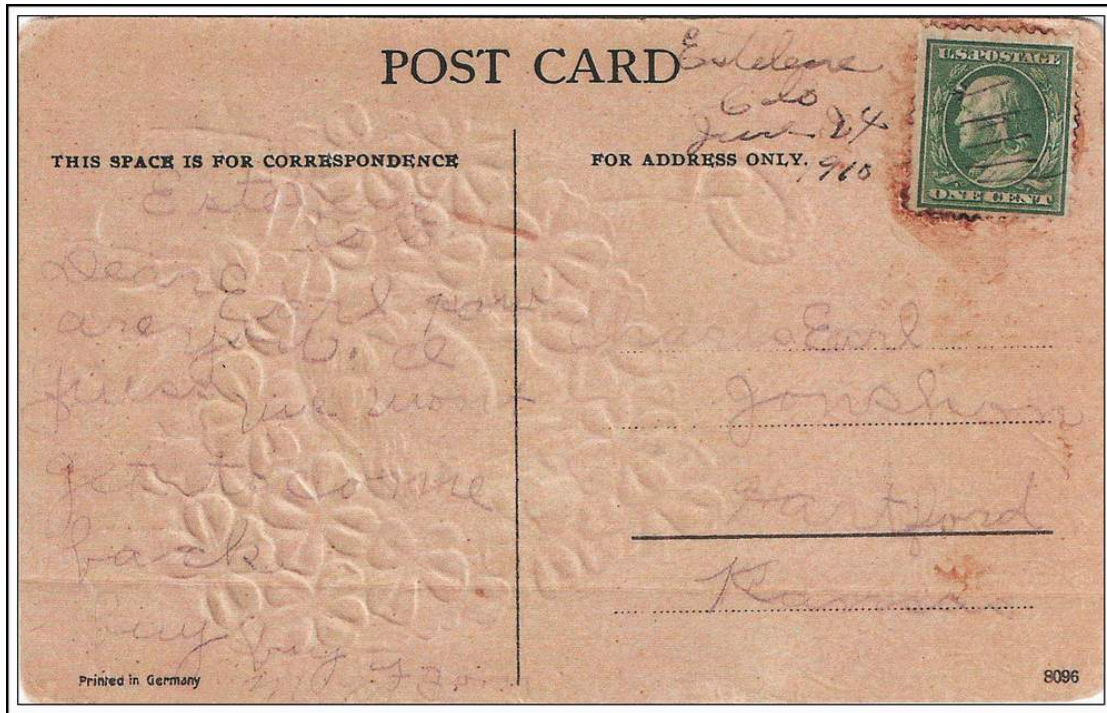

Estelene / Colo

June 24, 1910

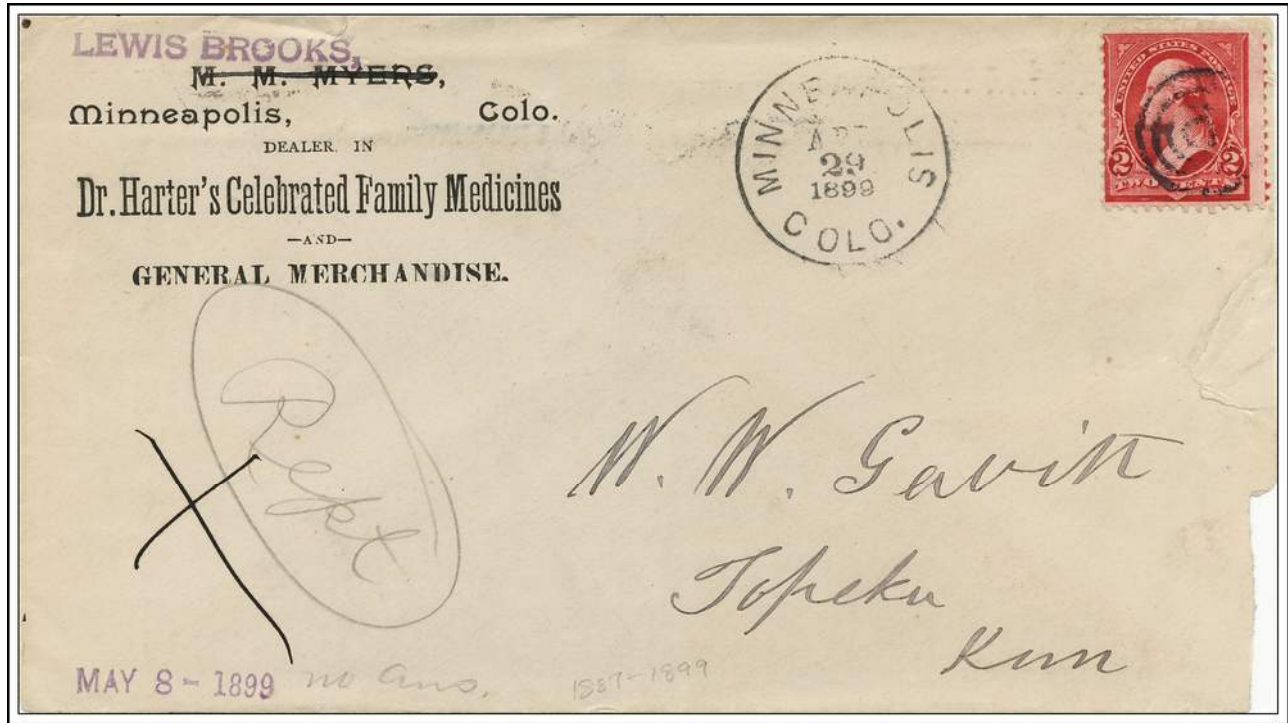

MINNEAPOLIS / COLO.

April 29, 1899

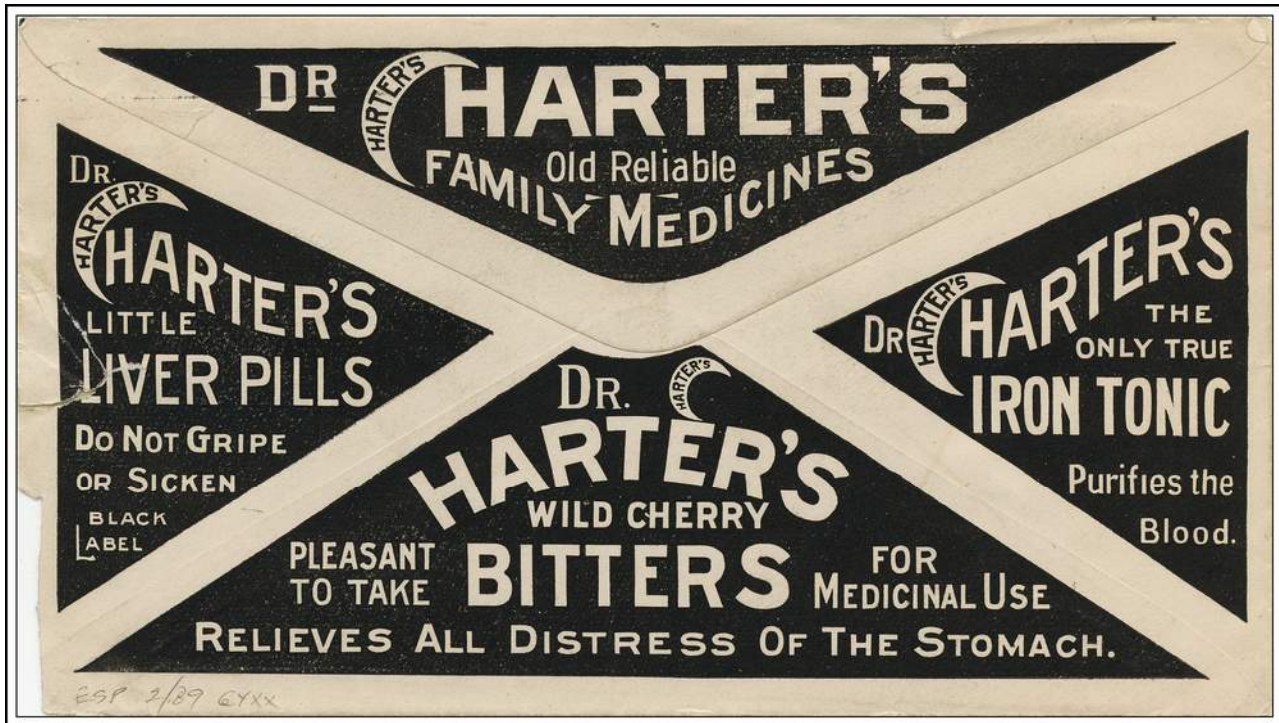

Reverse of Minneapolis cover above

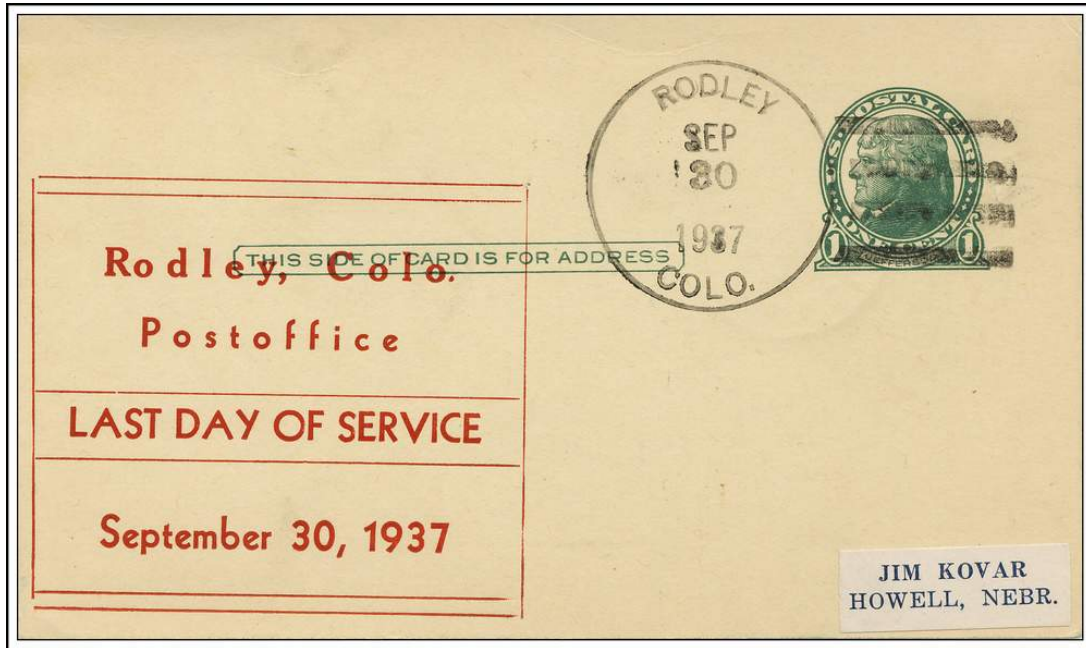

RODLEY / COLO. Last Day of Service September 30, 1937

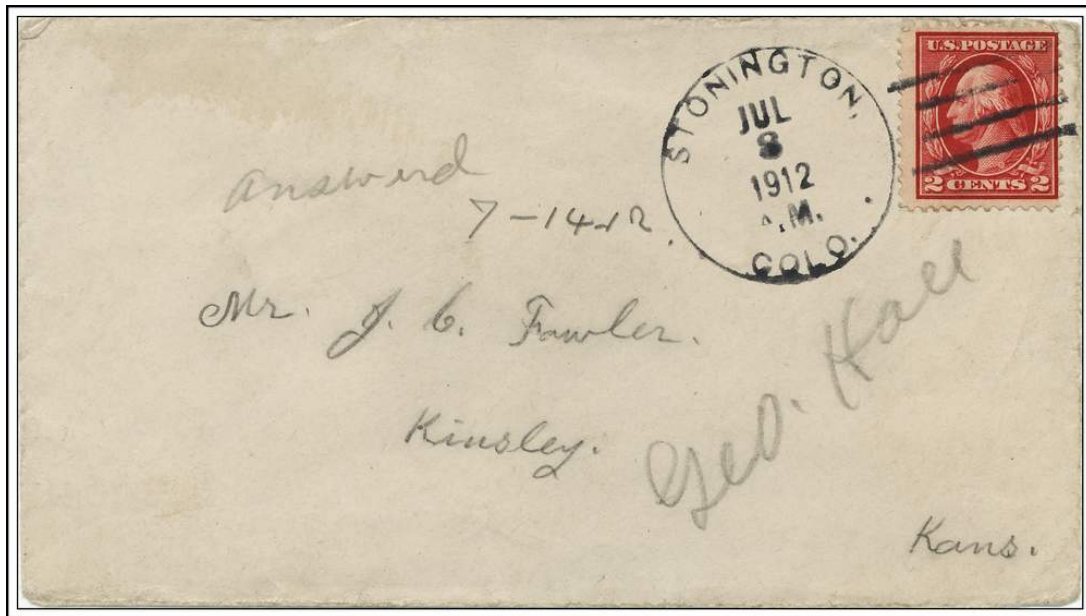

STONINGTON, / COLO. July 8, 1912

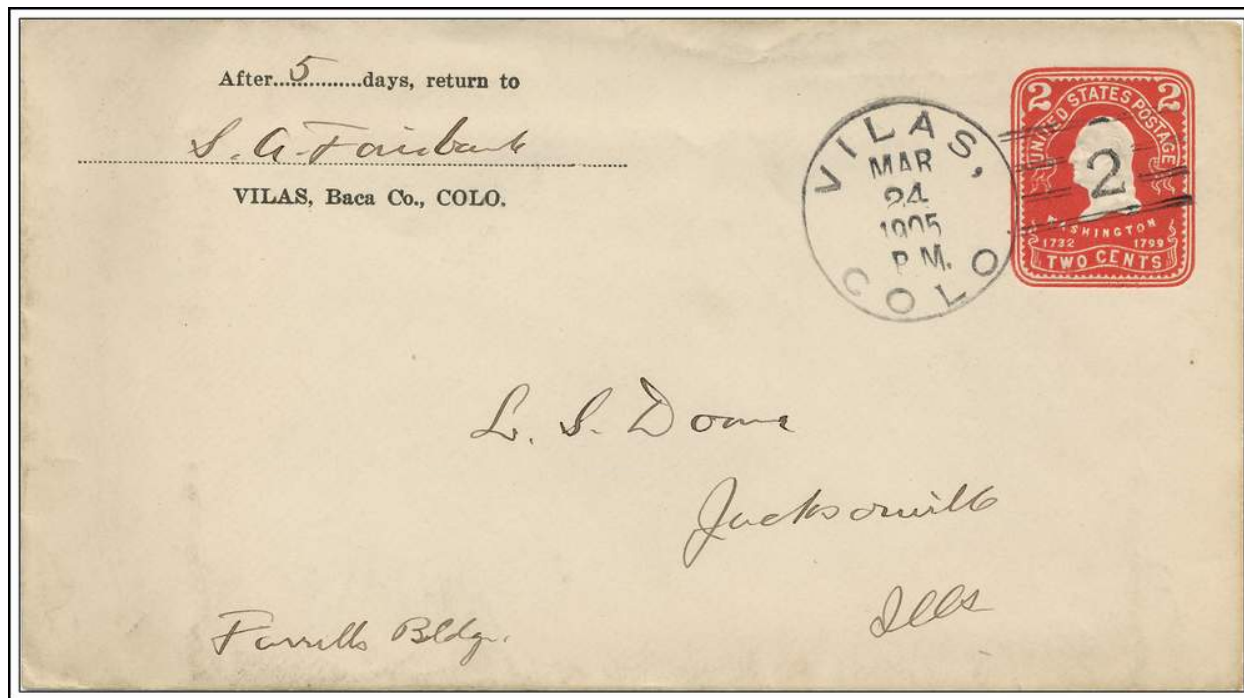

VILAS, / COLO. March 24, 1905



VILAS, COLORADO / U. S. P S CENTENNIAL STATION / 81087 June 20, 1987

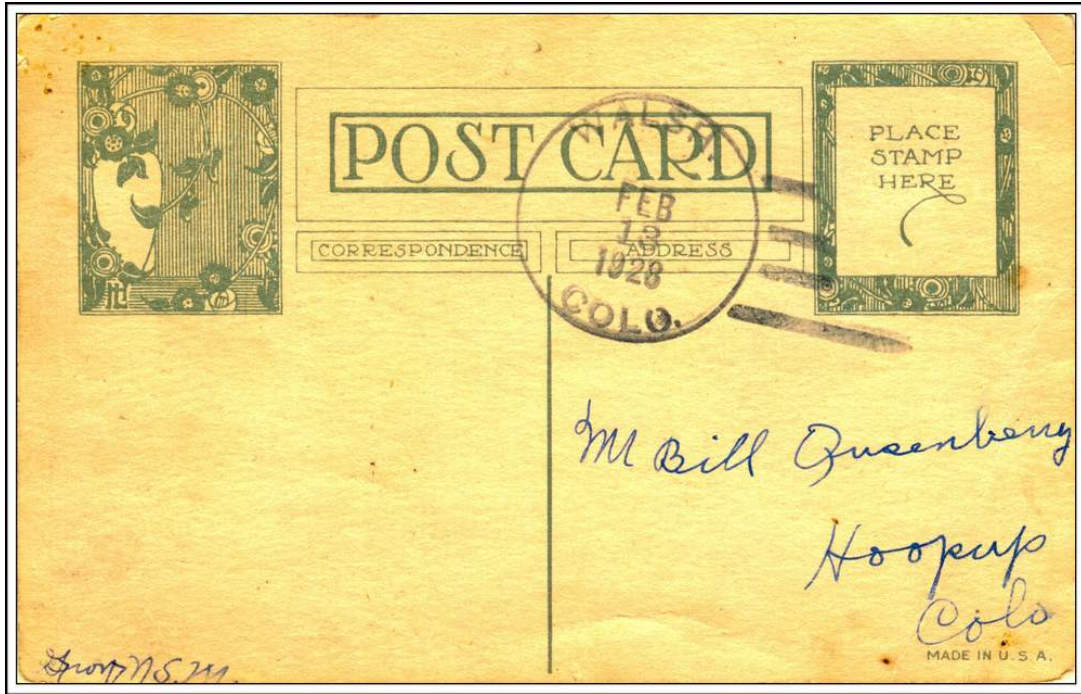

WALSH, / COLO.

February 13, 1928

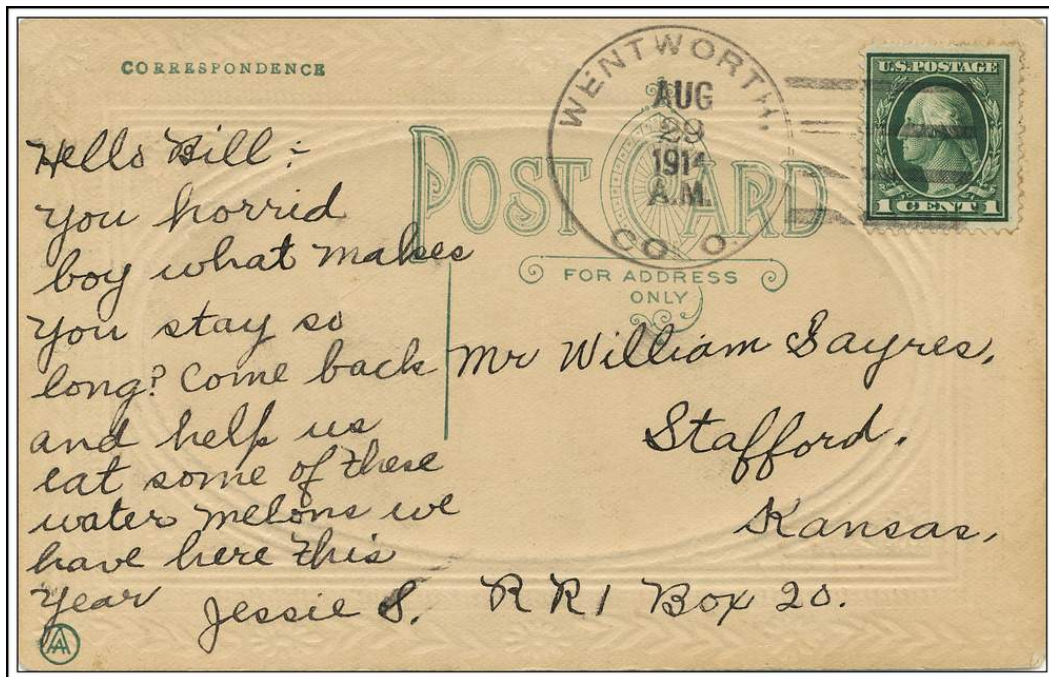

WENTWORTH, / COLO.

August 29, 1914

